

A向24° a与b通

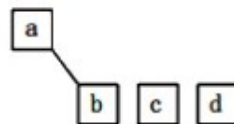

B向24° a与d通

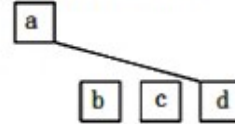

C向150g
a与c通

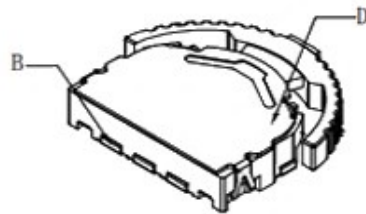
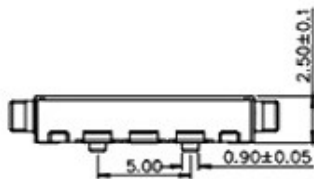
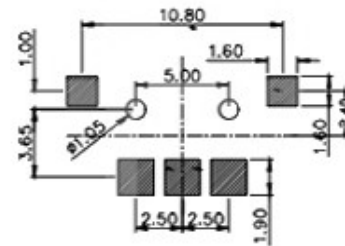
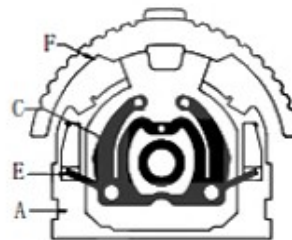
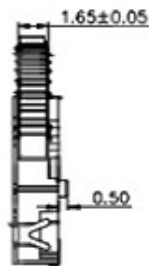
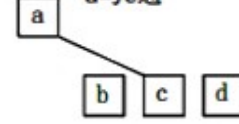

材料:

- A基座: 尼龙(黑色)
- B卡件: 磷铜(银白色与镀银)
- C簧片: 复银铜(白色)
- D盖子: 不锈钢(原色)
- E弹簧: 不锈钢丝(原色)
- D手柄: 尼龙(黑色)

主要技术规格:

1. 额定值: 0.1A DC12V
2. 接触电阻: 100mΩ
3. 操作力: 80gf±50gf
4. 行程: 1.0±0.2mm
5. 绝缘电阻: 100MΩ
6. 抗电强度: 110V 50HZ 1Min.
7. 寿命: 10万Cycles

DONG GUAN XI BANG ELECTRONIC CO., LTD

COPYRIGHT RESERVED, PLEASE DO NOT COPY.

PART NAME		MULTI FUNCTION SWITCH		DRAWING		Y.C.ZHANG	DWG.No.	SBICL
PART NO.				CHECK		G.C.Chen	REV.	A1
UNIT : mm	TOLERANCE	UP TO 5	±0.2	ANGLE	APPROVAL		DATE	
	OTHERWISE	ABOVE 5~30	±0.3		SCALE	2:1	PAGE	1 OF 1