

规格	DIM A	DIM B
BC3P3QH720D	7.2	5.7
BC3P3QH690D	6.8	5.3
BC3P3QH600D	6.0	4.5
BC3P3QH540D	5.4	3.9
BC3P3QH500D	5.0	3.5
BC3P3QH460D	4.6	3.1

性能:

- 额定电流: 2.0A
- 额定电压: 12V
- 耐电压: 500V
- 接触电阻: 30mΩ
- 绝缘电阻: 500MΩ
- 工作温度: -40℃~+85℃
- 塑件(材质): LCP
- 接触点(材质): 磷铜, 镀金

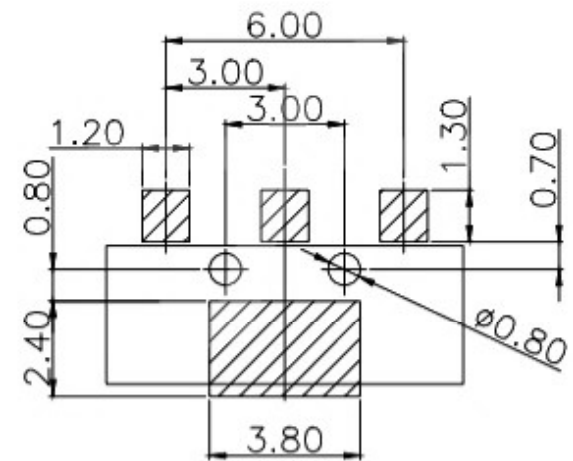

RECOMMENDED PCB LAYOUT  
TOL:(±0.05)

PART NAME		CONNECTOR			DRAWING	Y,C,ZHANG	DWG.No.	SBICL
PART NO.					CHECK	G.C.Chen	REV.	A1
UNIT : mm	TOLERANCE	UP TO 5	±0.2	ANGLE	APPROVAL		DATE	10-06-2012
	OTHERWISE	ABOVE 5~30	±0.3		SCALE	2:1	PAGE	1 OF 1