

尺寸范围	未注公差值
0~3	±0.1
3~6	±0.15
6~9	±0.2
9~12	±0.25
12~15	±0.3

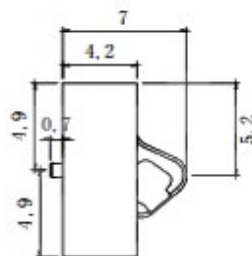
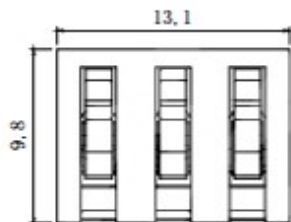

SPECIFICATIONS

1. ELECTRICAL CHARACTERISTICS:

- 1-1.RATING: DC 12V 2A
- 1-2.CONTACT RESISTANCE: 20mΩ MAX(INITAL)
- 1-3.DIELECTRIC WITHSTANDING VOLTAGE:
500V AC FOR ONE MINUTE
- 1-4.INSULATION RESISTANCE: 100MΩ MIN,
MEASURED BY 500V DC

2. LIFE TEST:MECHANICAL LIFE TEST 10,000 CYCLES.

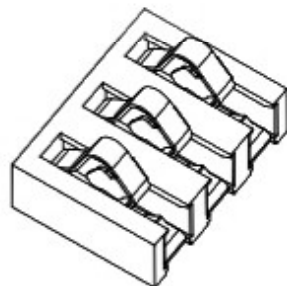
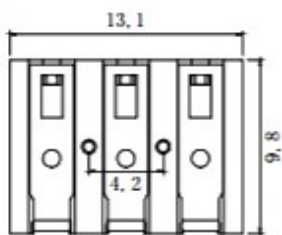

2	1#脚	3	不锈钢	镀金	国产
1	底座	1	LCP	白色	国产
序号	名称	数量	材料	颜色	备注
NO.	DESCRIPTION	Q'TY	MATERIAL	COLOR	REMARK



东莞市溪榜电子有限公司

COPYRIGHT RESERVED PLEASE DO NOT COPY.

PART NAME		CONNECTOR			DRAWING	Y,C,ZHANG	DWG.No.	SBICL
PART NO.					CHECK	G.C.Chen	REV.	A1
UNIT : mm	TOLERANCE	UP TO 5	±0.2	ANGLE	APPROVAL		DATE	26-07-2013
	OTHERWISE	ABOVE 5~30	±0.3		SCALE	2:1	PAGE	1 OF 1