

性能:

- 额定电流: 3.0A
- 额定电压: 60V
- 耐电压: 500V
- 接触电阻: 30mΩ
- 绝缘电阻: 500MΩ
- 工作温度: -55℃~+125℃
- 使用寿命: 10000次以上
- 塑件(材质): PA9T
- 接触点(材质): 黄铜C2680, 镀金

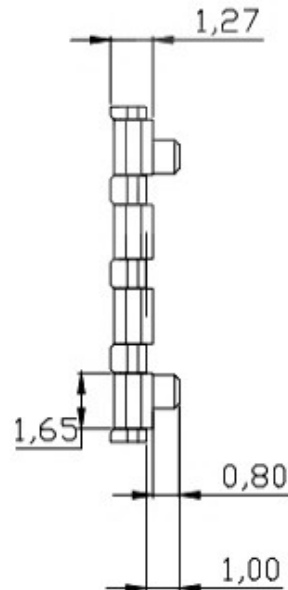

CONNECTOR

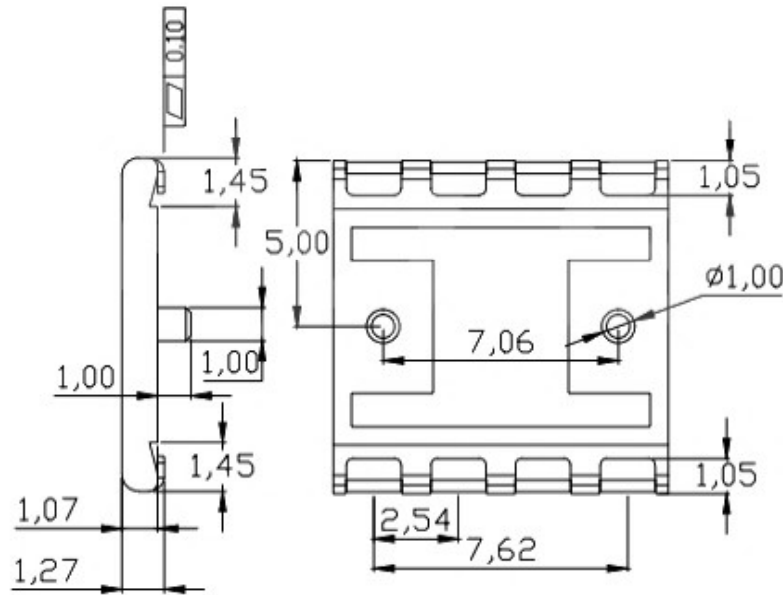
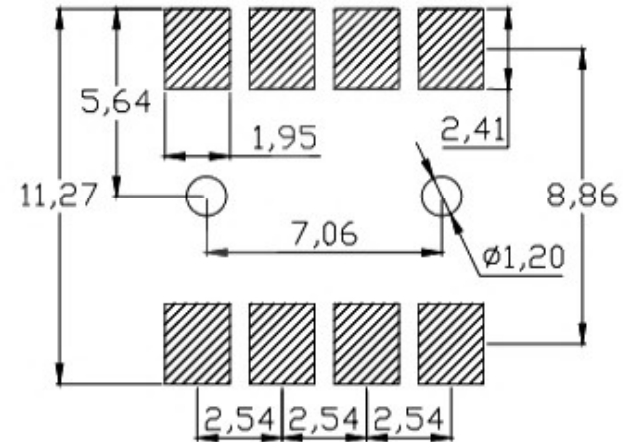

RECOMMENDED PCB LAYOUT

TOP VIEW(.XX±0.05)

PART NAME		CONNECTOR			DRAWING	Y,C,ZHANG	DWG.No.	SBICL
PART NO.					CHECK	G.C.Chen	REV.	A1
UNIT : mm	TOLERANCE	UP TO 5	±0.2	ANGLE	APPROVAL		DATE	13-09-2016
	OTHERWISE	ABOVE 5~30	±0.3				SCALE	2:1