

P.C.B LAYOUT

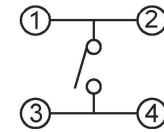

SCHEMATIC

SPECIFICATION

Contact Rating: 50mA,12V DC
 Contact Resistance: 100mΩ max
 Insulation Resistance: 100mΩ min.500V DC
 Dielectric Strength: 250V AC/1minute
 Travel: 0.25mm
 Operating Temp: -30℃~+85℃
 Storage Temp: -30℃~+80℃

PAPT NO	TS-1103ST-X-X
Operating force	B:160gf C:260gf
Fixed column	A:With B:without
Height	H:7.3

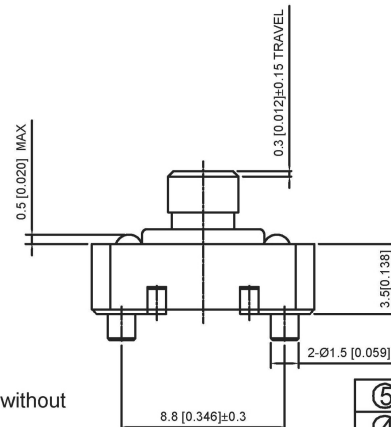
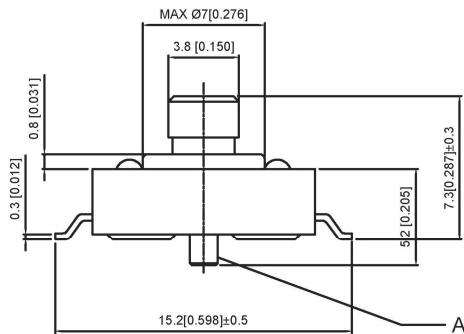

ITEM	PAPT NAMF	TER,NO	QTY	MATERIAL	FINISHING	REMARK
⑤	Terminal	—	4	Brass (0.30t)	Plating silvering	——
④	Contact	—	1	F.ag/Sus	Natural	——
③	Base	—	1	Pa46		——
②	Cover	—	1	Spcc	Plating Nickel	——
①	Keystake	—	1	Pa46		——

DSND		DATE		SCALE: N/A	MODEL TYPE: TACT SWITCH	
DWN		DATE		VIEW:	PART NO.:	
CHKD		DATE		UNIT: mm/in	DWG NO	
APPD		DATE		SIZE: A4	TS-1103ST-X-X	
DONG GUAN XI BANG ELECTRONIC CO., LTD				WEIGHT	SHEET	REVISION
				1.0g	1/1	A0

MARK	DESCRIPTION	DATE	REVISED	APPROVED	units: mm	tolerance:
ΔX					X.X	±0.2mm
ΔX					X.XX	±0.1mm
ΔX					X.XXX	±0.05mm
REVISIONS					UNSPECIFIED TOLERANCES	
www.alpsr.com www.gdxdz.com www.xbswitch.com						