

5" 678&*9"	
○ 1#	9:;<=
○ 3#	56):*5* 7>89:;&%
○ 2#	5 >9: ?; @-

**SPECIFICATION**

1. Rating : DC 20V 7A;
2. Contact resistance:  $\leq 0.03 \Omega$ ;
3. Insulation resistance:  $\geq 100M \Omega$  (DC250V);
4. Withstand voltage: 500VAC ;
5. Insertion and extraction force: 5-30N;
6. life test: 5,000 cycles.
7. PLUG 插入后上下左右4个方向无瞬断现象。

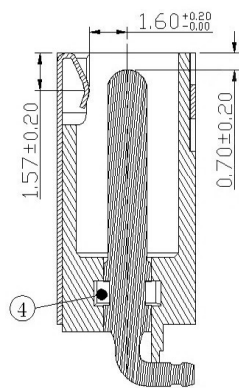

**SECTION B-B**

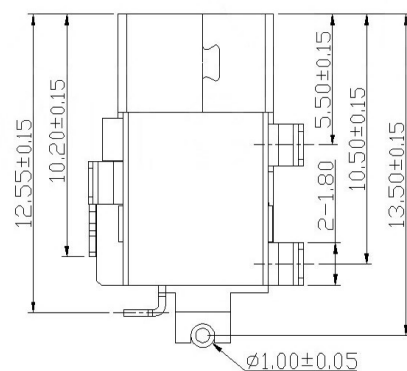

**SECTION A-A**

	MATERIAL	PLATING
center pin	Brass	tin
coat	Sus	
terminal 1	Phosphor Bronze	tin
terminal 2	Phosphor Bronze	tin
terminal 3	Phosphor Bronze	tin
plastic	Pa9t	

MARK	DESCRIPTION	DATE	REVISED	APPROVED	UNSPECIFIED TOLERANCES	DSND	DATE	SCALE: N/A	MODEL TYPE: DC POWER JACK
△X					ANGULAR ±5°	DWN	DATE	VIEW: ④	PART NO.:
△X					X.X ±0.2mm	CHKD	DATE	UNIT: mm	DWG NO.:
△X					X.XX ±0.1mm	APPD	DATE	SIZE: A4	DC-C024E-7A-1.65
					X.XXX ±0.05mm				WEIGHT 1.0g
									SHEET 1/1
									REVISION A0