

REVISION A RoHS

SYMB	REVISION	DATE	APVD.

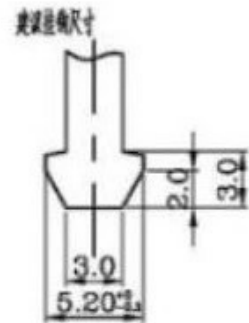
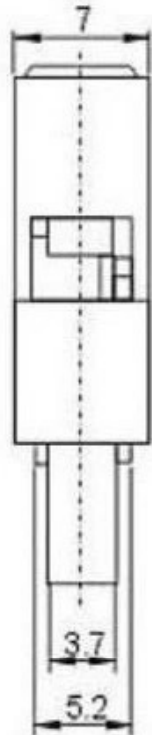
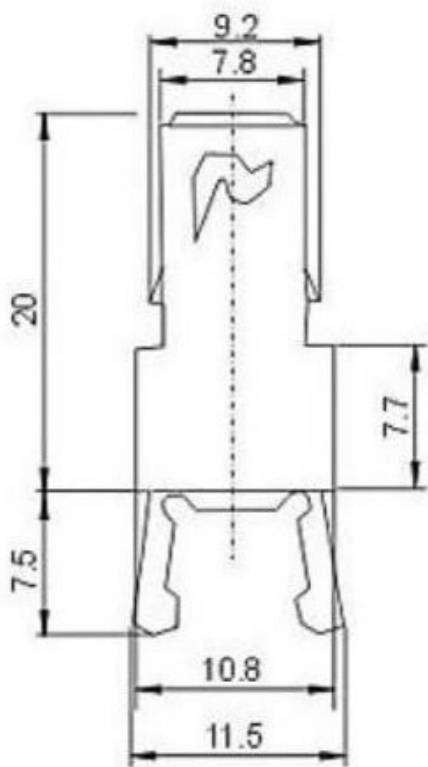

主要技术规格:  
 寿命次数: 50000次  
 按力: 400-600gf  
 接触电阻: ~30mΩ  
 温度范围: -25~+85℃  
 额定负荷: DC 12V 0.1A  
 耐压: AC 250V (50Hz) /min  
 绝缘电阻: ≥100MΩ  
 承受最大拉力: 1000gf

产品构造			外型
A	外壳	PA66	
B	盖板	PBT	
C	压簧片	PCM	
D	推轴	PA6	
E	接触簧	磷铜镀银	
F	钩针	钢丝	
G	接脚	黄铜镀银	
H	弹簧	T9A镀镍	

TITLE	DOOR LATCH SWITCH	DRAWN	TOLERANCE OTHERWISE UNLESS SPECIFIED		8				
PART NO.		CHECKED	UP TO 5	±0.2	6				
DRAW NO.	DL1	APPROVED	ABOVE 5 ~ 30	±0.3	5				
SCALE: 2:1	UNIT: mm	DATE:	ABOVE 30 ~ 50	±0.4	4				
			ABOVE 50	±0.5	3	SPRING	SUS	1	NI PLATED
			ANGLE	±3'	2	HOUSING	POM	1	BLACK
					1	SLIDER	PA12	1	BLACK
					NO.	PARTS	MATERIAL	QTY.	FINISHING

東莞市溪榜電子有限公司  
 Dongguan Xi Bang Electronic Co., Ltd