

电路简图

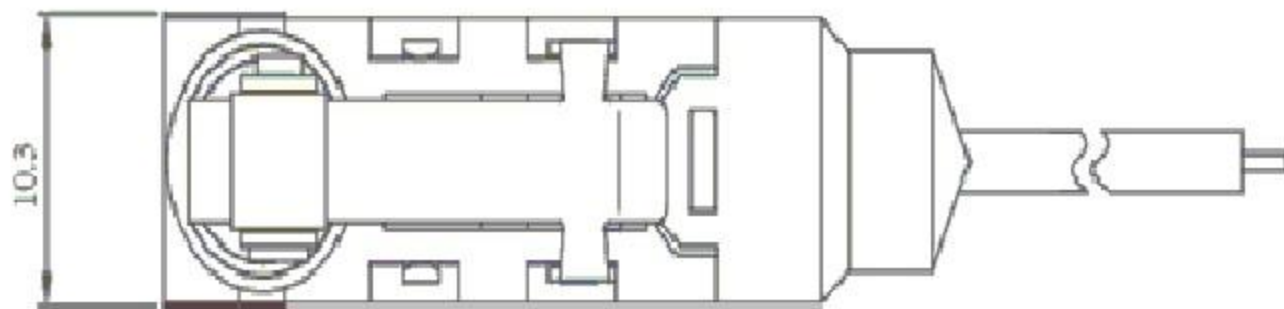
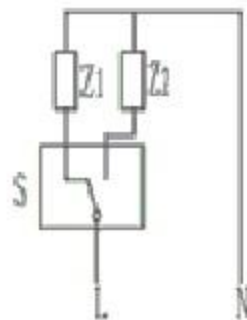

开关技术特性(Switch technical Characteristics):

| 项目 (ITEM) | 技术参数 (technical parameter)   | 特性值 (Value)  |
|-----------|--|--|
| 1         | 电气额定值 (Electrical Rating)  | 5(2)A 250VAC   |
| 2         | 动作力 (Operating Force)  | 1.0~5.0N   |
| 3         | 动作行程 (Pretravel)   | 0.6~1.5mm  |
| 4         | 接触电阻 (Contact Resistance)  | ≤50mΩ (初始值 Initial value)  |
| 5         | 绝缘电阻 (Insulation Resistance)   | ≥100MΩ (500VDC)  |
| 6         | 耐压强度 (Dielectric Voltage)  | 同极不相接端子间 (between non-connected terminals)   |
|           |  | 端子与外壳或非载流金属零件之间 (between terminals and the metal frame)  |
|           |  | 500V/0.5mA/60S   |
|           |  | 1500V/0.5mA/60S  |
| 7         | 电气寿命 (Electrical Life)   | ≥10000 cycles  |
| 8         | 机械寿命 (Mechanical Life)   | ≥100000 cycles   |
| 9         | 工作温度 (Operating Temperature)   | -25~85℃  |
| 10        | 操作频率 (Operating Frequency)   | 电气 (electrical) : 15 cycles<br>机械 (Mechanical) : 60 cycles   |
| 11        | 抗振动 (Vibration Proof)  | 振动频率 (Vibration Frequency) : 10~55HZ;<br>振幅 (Amplitude) : 1.5mm;<br>三向 (Three directions) : 1H             |
| 12        | 可焊性 (Solder Ability): 超过 80% 的浸锡面积被焊料所覆盖 (More than 80% of immersed part shall be covered with solder) | 焊接温度 (Soldering Temperature): 235±5℃<br>浸渍时间 (Immersing Time): 2~3S  |
| 13        | 耐焊接热 (Solder Heat Resistance)  | 自动焊接 (Dip Soldering) : 260±5℃ 5±1S<br>手工焊接 (Manual Soldering) : 300±5℃ 2~3S                                |
| 14        | 安全认证 (Safety Approvals)  | UL, CSA, CQC   |
| 15        | 测试条件 (Test Conditions)   | 环境温度 (Ambient Temperature) : 20±5℃<br>相对湿度 (Relative Humidity) : 65±5%RH<br>大气压 (Air Pressure) : 86~106KPa |

| NO. | PARTS     | MATERIALS          | Q'TY |                | TOLERANCE UNLESS SPECIFIED   |       |           |                          |           |
|-----|-----------|--------------------|------|----------------|------------------------------|-------|-----------|--------------------------|-----------|
| 8   |           |                    |      |                |                              |       |           |                          |           |
| 7   |           |                    |      |                |                              |       |           |                          |           |
| 6   |           |                    |      |                | WITHIN 1.5mm : ±0.1mm        | A     | 2012-8-13 | 初版                       |           |
| 5   | SPRING    | SUS                | 1    | NATURAL        | OVER 1.5mm : ±0.2mm          | ISSUE | DATE      | DESCRIPTIONS OF REVISION |           |
| 4   | CAM STICK | SUS                | 1    | NATURAL        | TITLE : <b>Miicro Switch</b> |       |           | UNIT : mm                | DRWG NO.: |
| 3   | CASE      | PA66/BRASS STRIP   | 1    | GREY/Ag PLATED | MODEL:                       |       |           | SCALE: 5:1               | DWN.      |
| 2   | COVER     | PA66               | 1    | BLACK          | <b>东莞市溪榜电子有限公司</b>           |       |           |                          | 2012-8-13 |
| 1   | KNOB      | PA66/PBS C5210R-EH | 1    | WHITE/Ag CLAD  |                              |       |           | CHK'D                    |           |
|     |           |                    |      |                |                              |       |           | APPD.                    |           |