

NOTE

1. Material

Plunger: Brass
 Barrel: Brass
 Spring: SUS
 Housing: PA46

2. Plating

Plunger: Au over NI
 Barrel: Au over NI

3. Electrical

Rated current & voltage: DC 12V; 2.0A Max.

4. Mechanical

Spring force: 60g±20% at normal working height
 Durability: 10,000 cycles(minimum)

5. To ensure the best usage, please operate it based on the working height Based on the engineering drawings, shall not exceed the maximum allowed compression

6. To avoid arcing issue, The adaptor start to power supply after connector mated fully.



东莞市溪榜电子有限公司
 DONG GUAN XI BANG ELECTRONICS CO., LTD.

Switch Connector

TOLERANCE UNLESS OTHERWISE STATED :

Up to 5 ±0.2
 Above 5 ~ 15 ±0.3
 Above 15 ~ 30 ±0.4
 Above 30 ~ 50 ±0.5
 Angle ±0.3°

3RD. ANGEL'S

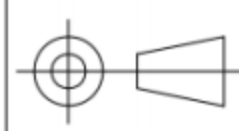

UNITS

MM

DRAWN BY: Jack Lu
 DATE: 04/01/21
 CHECKED BY: Jacky Chen
 DATE: 04/01/21
 APPROVED BY: Tony Kao
 DATE: 04/01/21

MAT'L		TITLE	CONNECTOR
FINISH		MODLE	POGO PIN
SCALE	1 : 1	DWG NO.	XB-PGC-D-M-1-119
SHEET NO.	1 of 1	PART NO.	Thimble Connector
		SIZE	A4
		VER	R

ITEM NO.	DESCRIPTION	DRAWN	DATE