

REV NO/版次	REVISION NOTE/修订注释	DATE/日期	SIGNATURE/签名

ELECTRICAL CHARACTERISTICS

1. RATING: DC 30V 0.5A
2. CONTACT RESISTANCE: 100mΩ MAX
3. INSULATION RESISTANCE: 100MΩ MIN
4. DIELECTRIC STRENGTH: AC 250V (50~60Hz) /60S

MECHANICAL CHARACTERISTICS

1. PRACTICAL TEMPERATURE RANG: -40℃~+85℃
2. OPERATING FORCE: 180±30gf
3. MECHANICAL LIFE: 1 0,000 cycles

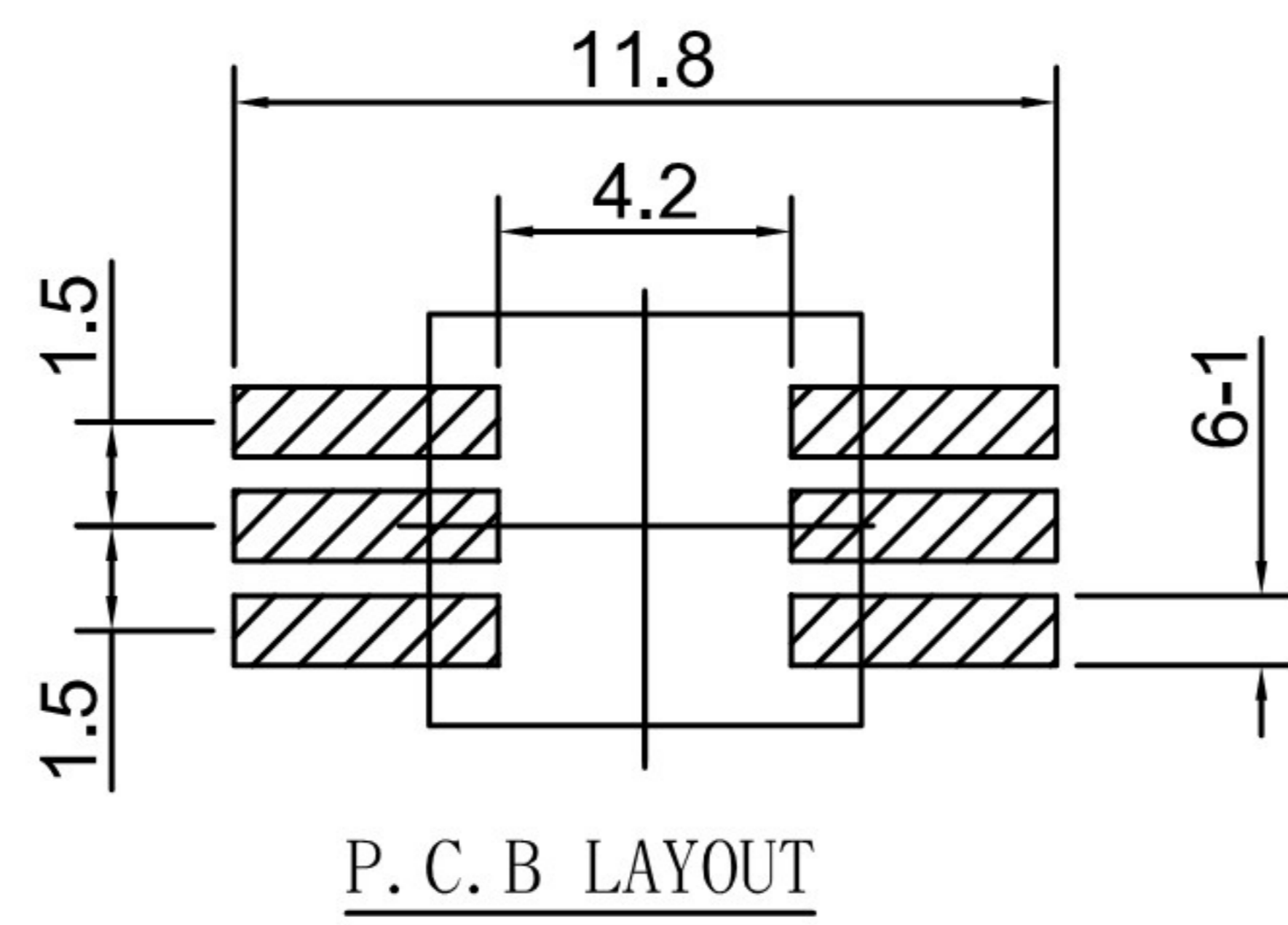
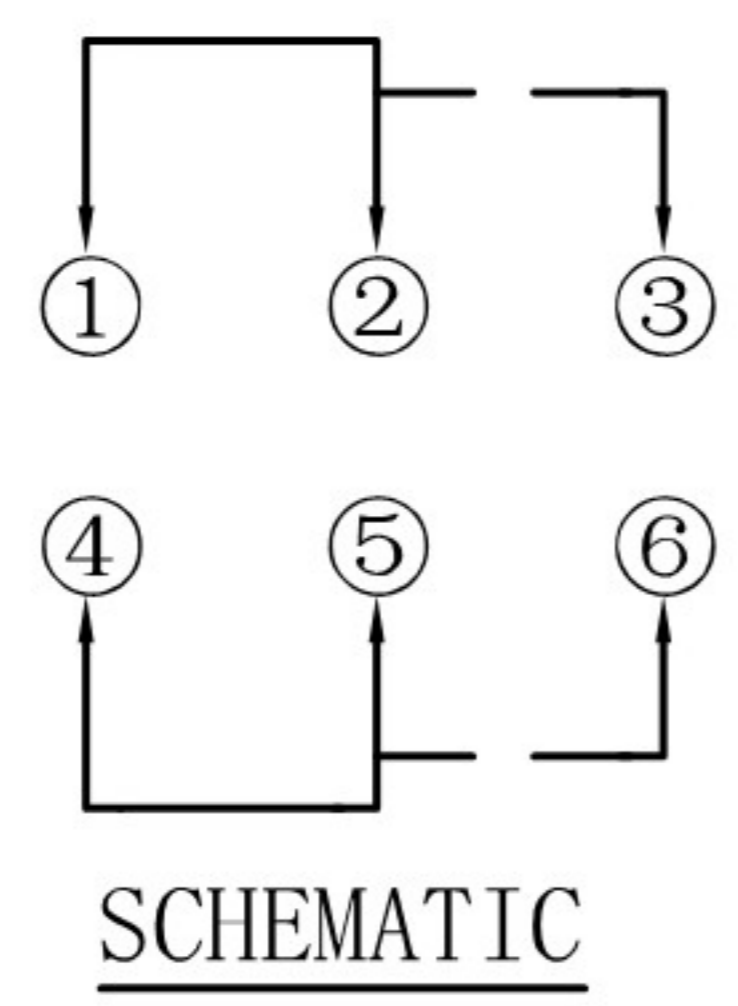
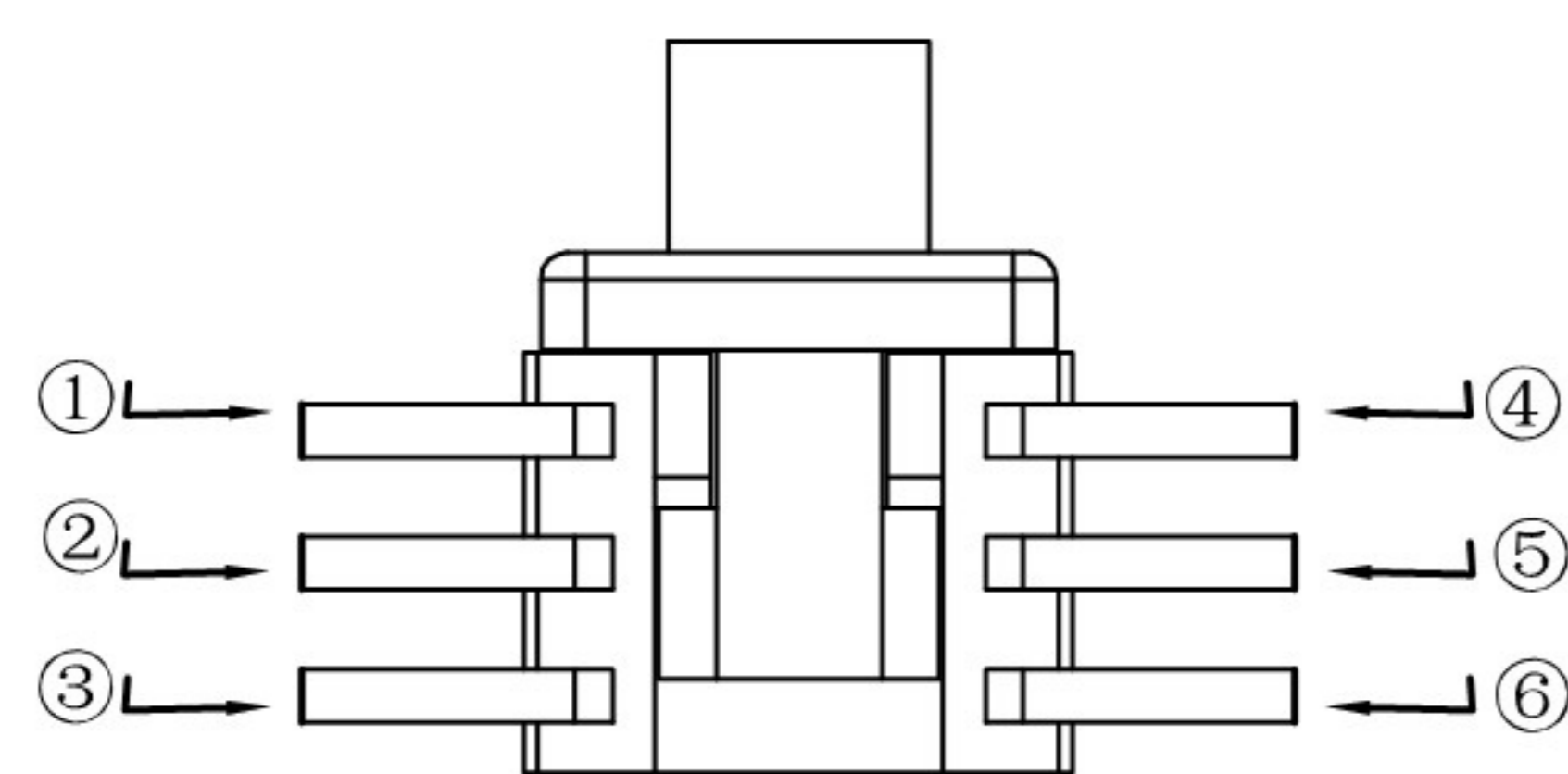
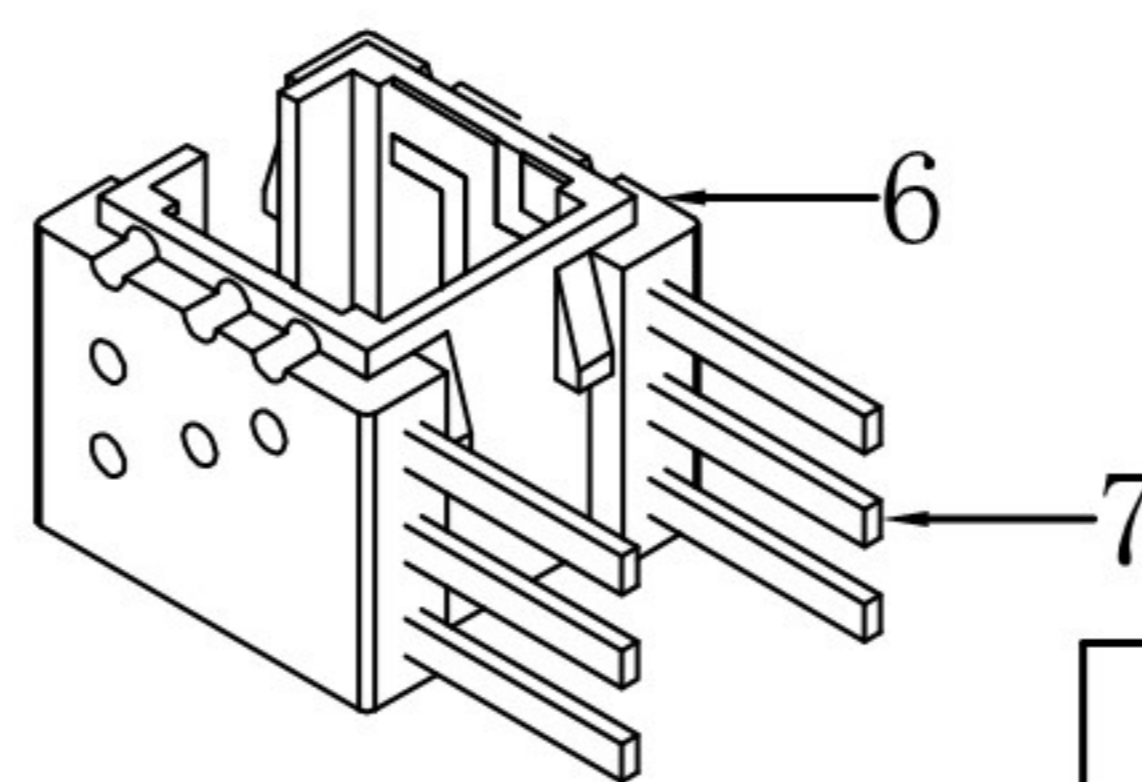
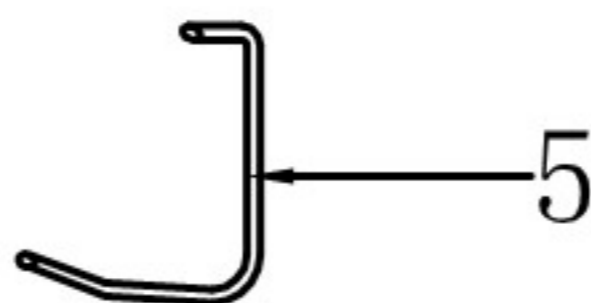
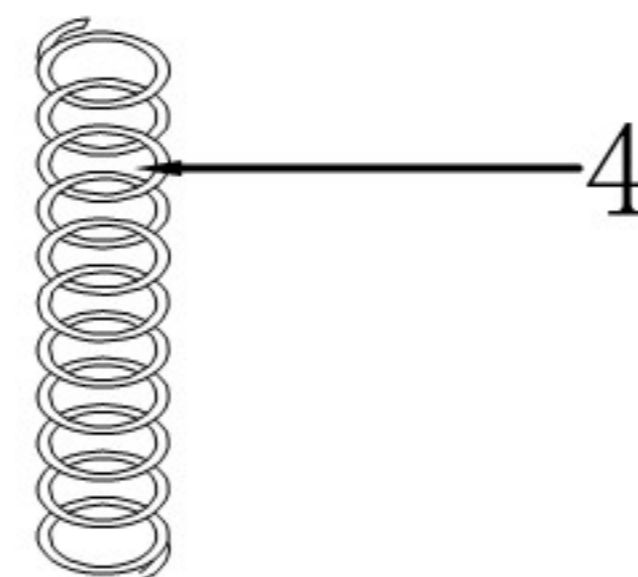
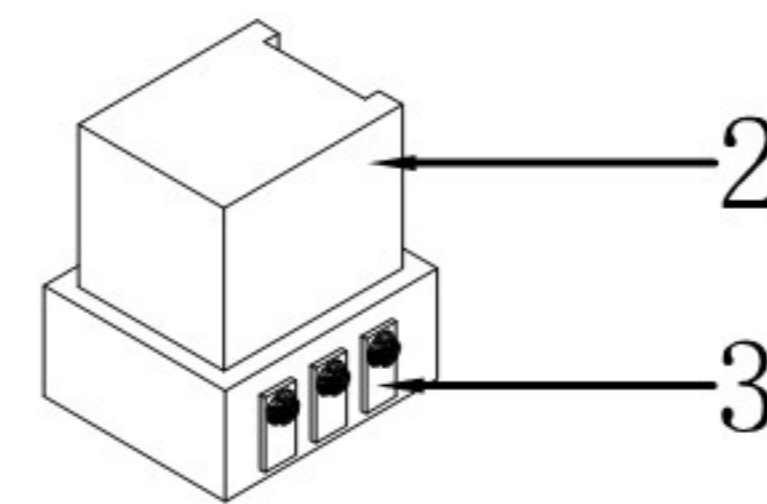
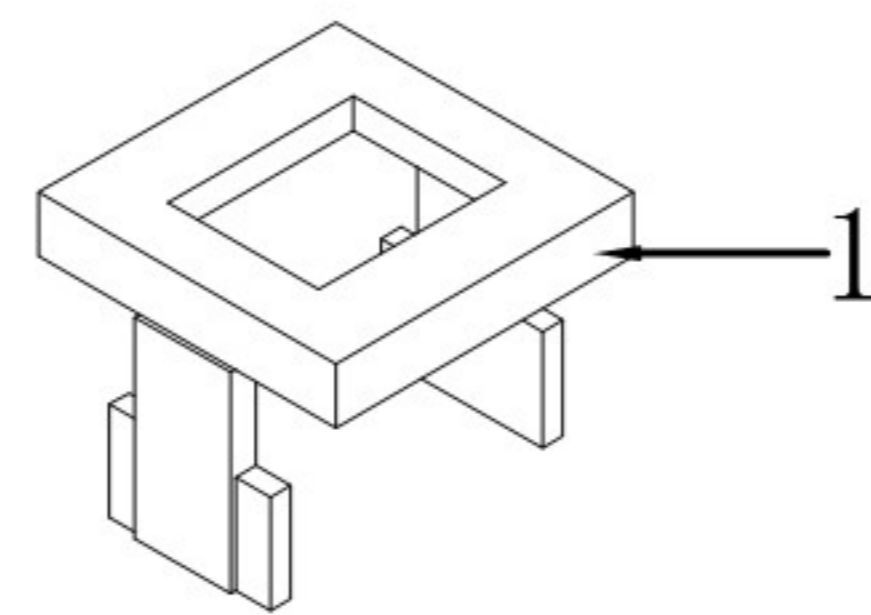
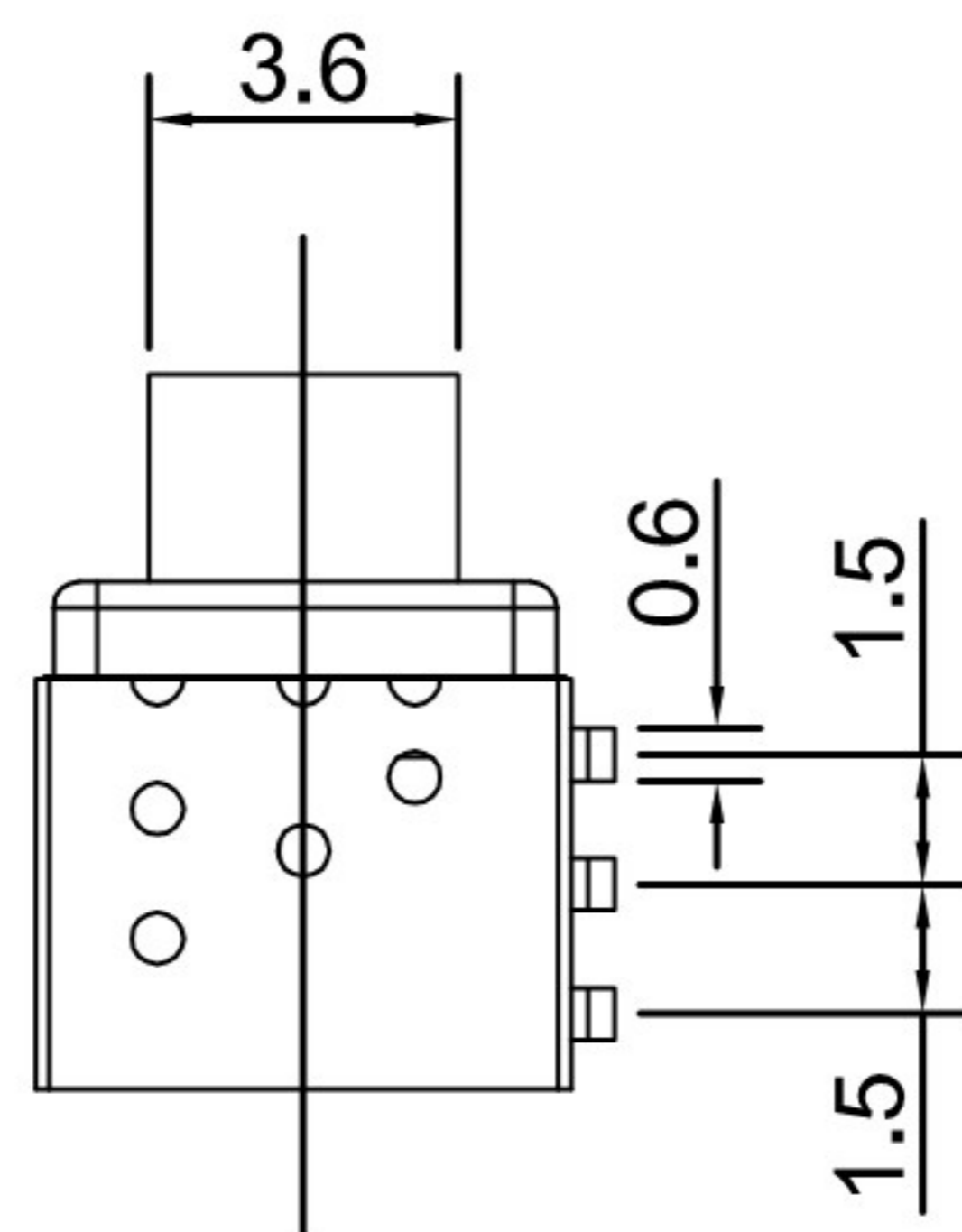
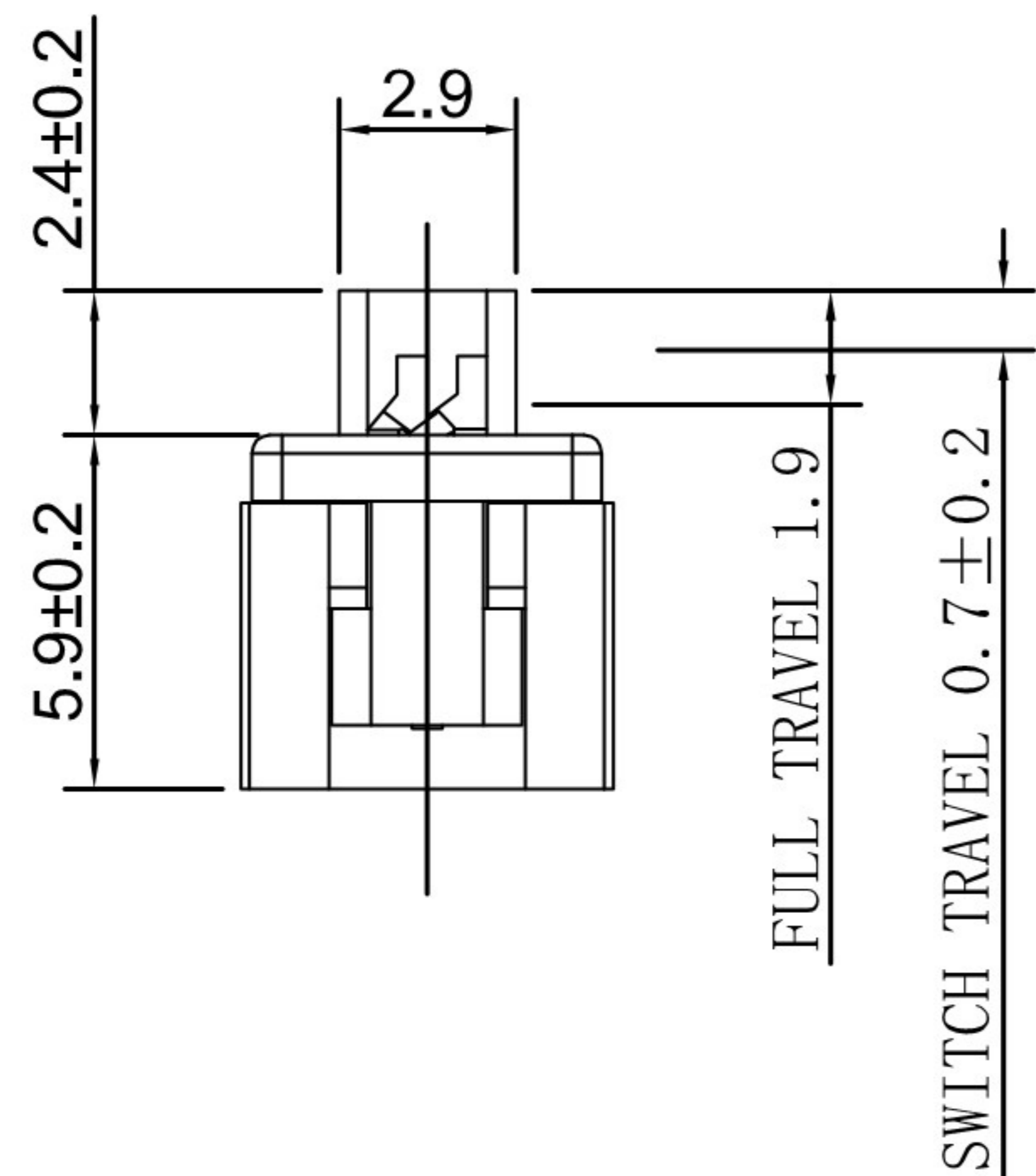
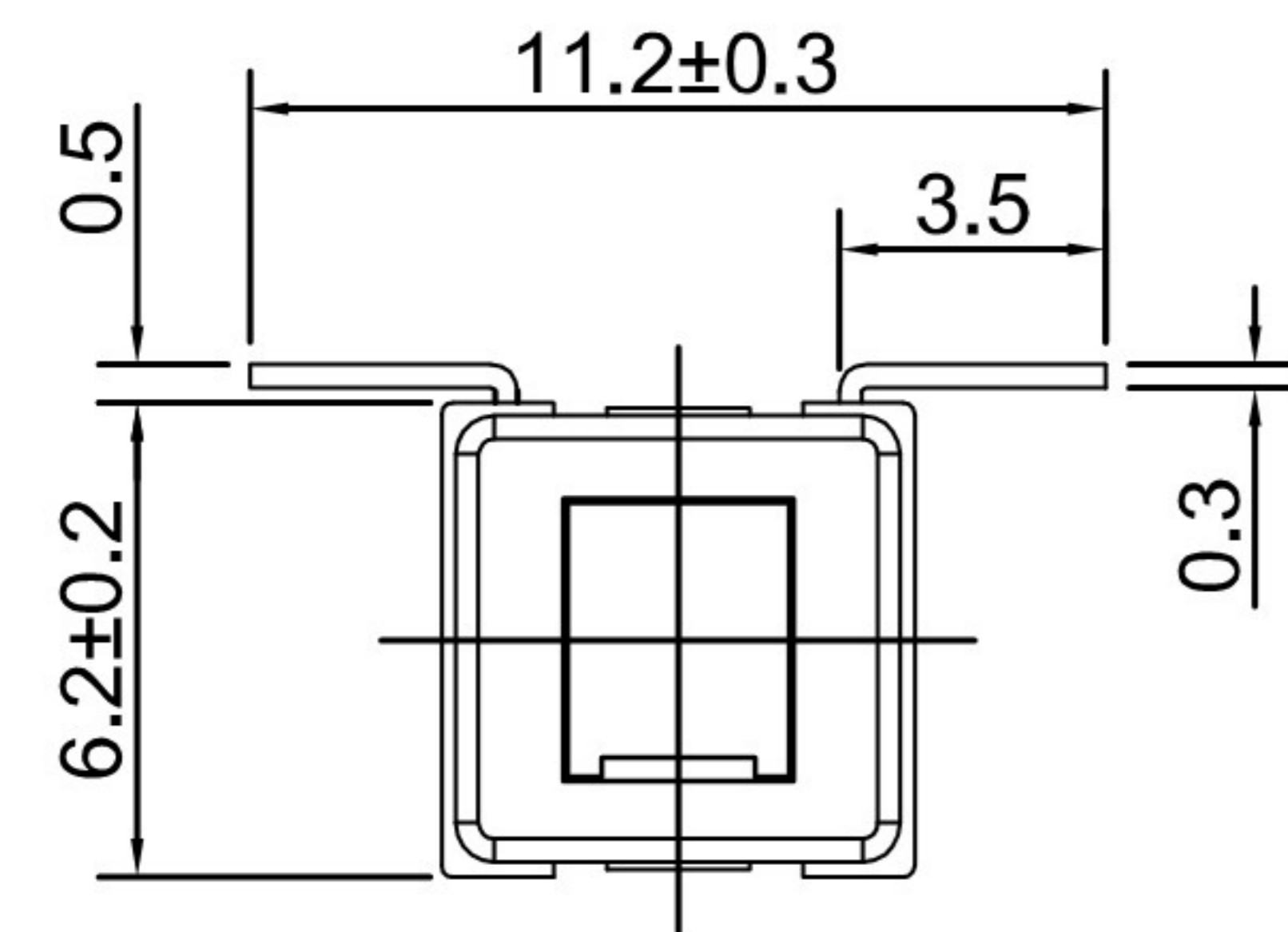

7	TERMINAL	BRASS	6	Ag PLATED
6	CASE	PPA	1	GRAY
5	LOCK PIN	SUS WIRE $\phi 0.35$	1	NATURAL
4	SPRING	SUS WIRE	1	NATURAL
3	CONTACT	BRONZE	2	Ag PLATED
2	KNOB	PPA	1	WHITE
1	COVER	PPA	1	BLACK
NO.	PART NAME	MATERIAL	QTY.	FINISHING



东莞市溪榜电子有限公司
DONG GUAN XI BANG ELECTRONICS CO., LTD.

GENERAL TOLERANCE未指的公差		TITLE	
X. ± 0.5	X.° ± 5°	名称 XB-5858-M-P	
.X ± 0.3	.X° ± 2°	PART NO. 零件编号	
.XX ± 0.2	.XX° ± 1°	DWG NO. 图纸编号	
.XXX ± 0.1	.XXX° ± 0.5°	XB-5858-M-P	
APPROVAL 审批	CHECKED 核准	DRAWN 设计	UNIT 单位 (mm)
ROBIN			SCALE 比例
			1:1
			PROJ.
			REV.