

ROHS

SWITCH+DC SOCKET TWO IN ONE TECHNICAL PARAMETERS

一、ROCKER SWITCH & SPECIFICATION

NOTES:

1. Rating: 6A 10A 125V 250V AC
CQC 6A 250VAC
6(8)A 250VAC
8A/128A 250VAC T105/55
UL CUL 10GPA 125VAC
6GPA 250VAC T105/55
VDE ENEC 6(4)A 250VAC T85/55
KC 6(4)A 250VAC T85/55
2. Circuit Diagram: 2P ON-OFF/3P ON-OFF-ON
3. Terminal Strength: $\geq 80N$
4. Electrical life: ≥ 10000 cycles
5. Withstand Voltage: Withstand Voltage: 1500VAC 1min
Terminals to Button: 3000VAC 1min
6. Leakage Current: $1mA$
7. Current resi stance: $\leq 50m\Omega$ (initial)
8. Insulation resistance: $2 > 100M \Omega$
9. Body Materil: NYLON 66 94V-2⁰

二、DC JACK & SPECIFICATIO

NOTES:

1. Rating : DC 12V 30V, 1A 3A
2. Contact resistance : $\leq 30m\Omega$
3. Insulation resistance : $> 100MN$
4. Withstand voltage : 500VAC
5. Insertion and extraction force : 3-20N
6. Electrical life : $> 10,000$ cycles

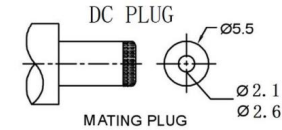
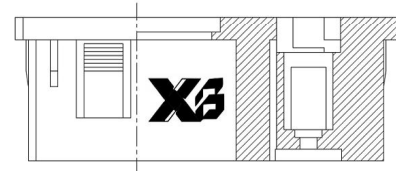
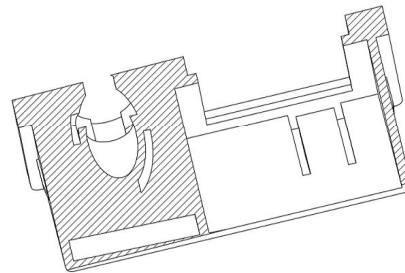
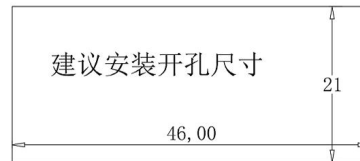
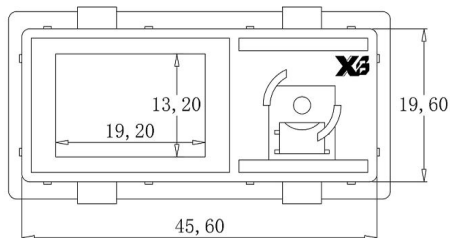
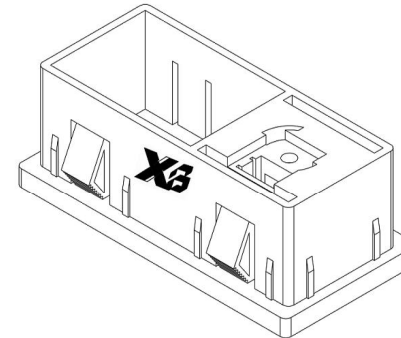
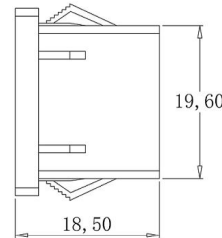
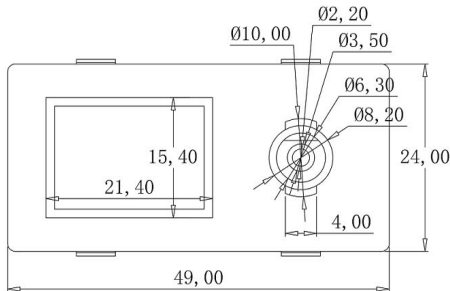
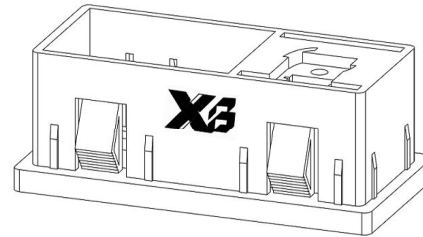
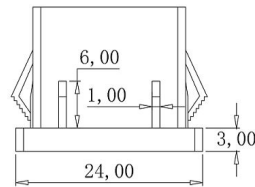
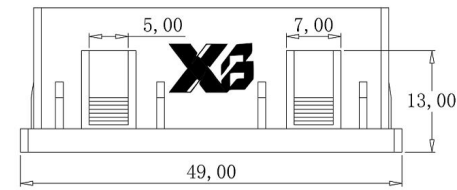

DC JACK SCHEMATIC	
CENTER PIN	$\phi 2.0mm$ $\phi 2.5mm$

OPTIONAL KNOB TYPE
SCALE: 2.5:1

SRA-1101A-F	SRA-1101A-E
SRA-1101A-D	SRA-1101A-C
SRA-1101A-B	SRA-1101A-A



东莞市溪榜电子有限公司
DONG GUAN XI BANG ELECTRONICS CO., LTD

TITLE : XB ROCKER SWITCH
MODEL : XB-RS-DC-13

TOLERANCE	ANGLE TOL
0.0 ± 0.3mm	± 2

UNIT : MM	DWN.	GAO. PENG	DATE	
SCALE : 2 : 1	CHK'D	PANG. DONG	DATE	
VERSION	01	APPD.	HE. LONG. FEI	DATE

8	CONTACT POINT	COPPER	1	Ag CLAD
7	SLEEVE	BRASS	1	Ni PLATED
6	SPRING	STEEL WIRE	1	NATURE
5	SPRING PLATED	COPPER STRIP	1	Ag PLATED
4	TERMINAL B	BRASS STRIP	1	Ag PLATED
3	TERMINAL A	COPPER STRIP	1	Ag PLATED
2	CASE	NYLON	1	BLACK
1	KNOB	NYLON	1	BLACK
NO.	PART NAME	MATERIAL	QTY.	FINISHING