



**XB-FPC -1001 D R 25 -XX X XX 01**

**XB connector**

**Series No**

**Termpoint**  
D-DIP

**Angle**  
R-90°

**Terminal Plating**  
BT-Bright Tin

**Housing Colour**  
S-Nature

**Pin Q' PY**  
06~30

**Height**  
25-2.50mm

**XB-FPC specifications:**

1. Current rated: 0.5A AC/DC
2. Voltage rating: 50V AC/DC
3. Withstanding voltage: 200V AC
4. Contact resistance: 20mΩ max.
5. Insulation resistance: 500MΩ min
6. Durability cycle: 20Cycles
7. Removal force: 0.05kgf/Pin min
8. Operating temperature range: -25°C ~ +85°C

**Ordering Information:**

Circuit	Dimensions(mm)			
	A	B	C	D
06	5.00	7.15	11.20	13.10
08	7.00	9.15	13.20	15.10
09	8.00	10.15	14.20	16.10
14	13.00	15.15	19.20	21.10
15	14.00	16.15	20.20	22.10
16	15.00	17.15	21.20	23.10
17	16.00	18.15	22.20	24.10
18	17.00	19.15	23.20	25.10
20	19.00	21.15	25.20	27.10
22	21.00	23.15	27.20	29.10
24	23.00	25.15	29.20	31.10
25	24.00	26.15	30.20	32.10
26	25.00	27.15	31.20	33.10
27	26.00	28.15	32.20	34.10
28	27.00	29.15	33.20	35.10
30	29.00	31.15	35.20	37.10

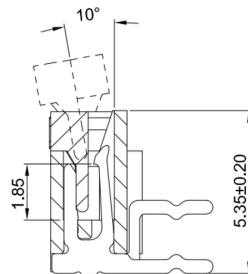
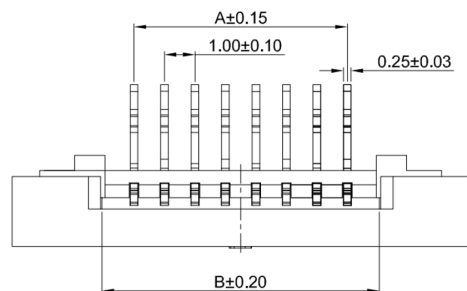

SECTION A-A

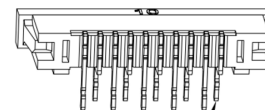
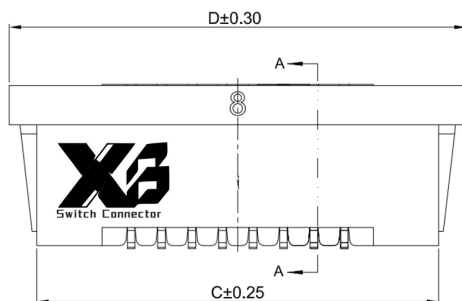
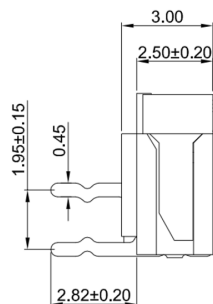

Circuit 1

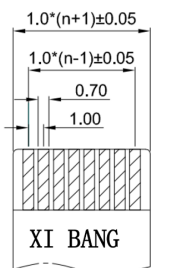

PROPER CABLE (SCALE 2:1)

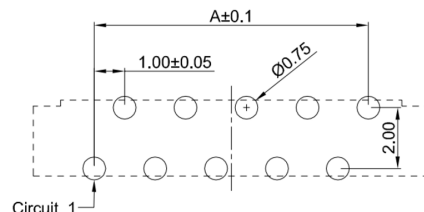
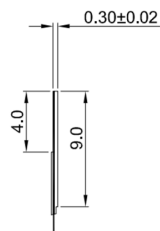

RECOMMENDED PCB LAYOUT  
TOLERANCE:±0.05



**东莞市溪榜电子有限公司**  
DONG GUAN XI BANG ELECTRONICS CO., LTD.

DRAWN BY: Jack Lu DATE: 03/10/22  
CHECKED BY: Jacky Chen DATE: 03/10/22  
APPROVED BY: Tony Kao DATE: 03/10/22

MAT'L		TITLE	CONNECTOR
FINISH		MODLE	FPC 1.00mm Pitch 90° Right DIP Double Row Single Sided Welding Bottom Contacts
SCALE	1 : 1	DWG NO.	XB-FPC-1001DR25-XXXXX01
SHEET NO.	1 of 1	PART NO.	

TOLERANCE UNLESS OTHERWISE STATED:  
 Up to 5 ±0.2  
 Above 5 ~ 15 ±0.3  
 Above 15 ~ 30 ±0.4  
 Above 30 ~ 50 ±0.5  
 Angle ±0.3

3RD. ANGEL'S

UNITS MM

1	更新圖面	Jack	03/10/22
ITEM NO.	DESCRIPTION	DRAWN	DATE

SIZE
A4
VER
R1