

2PIN 示意图

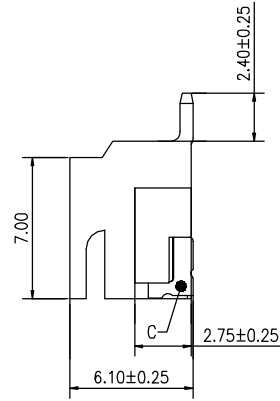

NOTES:

CURRENT RATING:3A AC/DC.
 VOLTAGE RATING:250V AC/DC
 TEMPERATURE RANGE:-40°C~+105°C.
 CONTACT RESISTANCE:10MΩ Max.
 INSULATION RESISTANCE:1000MΩ Min.
 WITHSTANDING VOLTAGE: 800V AC/MINUTE.
 MATERIAL:LCP UL94V-0.

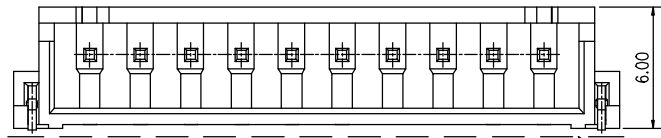

0.1 MAX

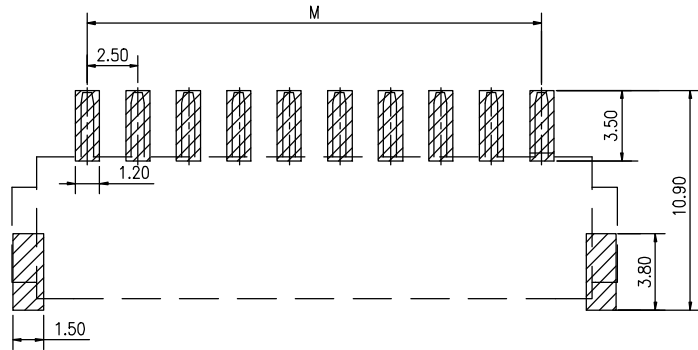

P.C.B LAYOUT

No. of PIN/ROW	Dimension Information		
	M	L	L1
02	2.50	7.50	10.00
03	5.00	10.00	12.50
04	7.50	12.50	15.00
05	10.00	15.00	17.50
06	12.50	17.50	20.00
07	15.00	20.00	22.50
08	17.50	22.50	25.00
09	20.00	25.00	27.50
10	22.50	27.50	30.00
11	25.00	30.00	32.50
12	27.50	32.50	35.00
13	30.00	35.00	37.50
14	32.50	37.50	40.00
15	35.00	40.00	42.50
16	37.50	42.50	45.00

Ordering Information

XB-X25-PCB-105-A001 XX A 001 C X Z X

No. of Pins per Row
02~16

Standard Plating
01=Tin
Selective Plating
02=Gold Flash
22=Matte Tin
...

Color
1=Black
2=White
...

Standard Packing
D=Tape&Reel
Selective Packing
B=Tray
...

XB 东莞市溪榜电子有限公司
DONG GUAN XI BANG ELECTRONICS CO.,LTD

3RD.ANG PROJ.

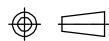

PAGE. 1/1

GENERAL TOLERANCE	
X.'±3.0'	X.±/
.X'±2.0'	.X±0.25
.XX'±1.5'	.XX±0.20
.XXX'±1.0'	.XXX±0.15

DESIGNED:

DATE:

DWG. NO.

TITLE.

CHECKED:

DATE:

XB-X25-PCB-105-A001

2.5mm pitch wafer SMT

APPROVED:

DATE:

PART NO.

REV.	UNIT.	SCALE.
A	mm	1:1

1 2 3 4 5 6 7 8 9

F

E

D

C

B

A

F

E

D

C

B

A

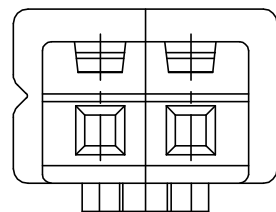

Specifications
 Current Rating:3Amp
 Voltage Rsting:250V AC/DC
 Temperature Range:-25°C to +85°C
 Contact Resistance:10mΩ Max.
 Insulation Resistance:1000MΩ Min.
 Withstanding Volatge:1000V AC/minute
 Materials
 Contact Material:PA66
 All materials must meet XI BANG
 hazardous substances control standards.

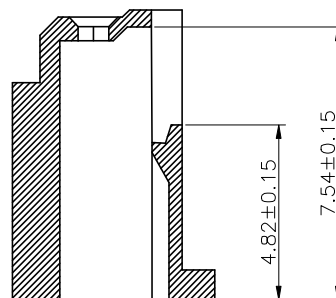
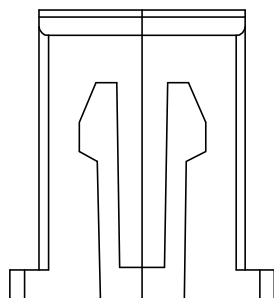
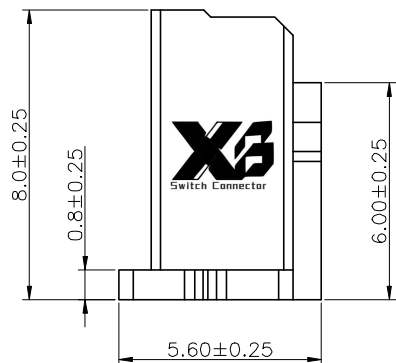

Pins	DIMENSIONS	
	L	M
02	7.30	2.5
03	9.80	5.0
04	12.30	7.5
05	14.80	10.0
06	17.30	12.5
07	19.80	15.0
08	22.30	17.5
09	24.80	20.0
10	27.30	22.5
11	29.80	25.0
12	32.30	27.5
13	34.80	30.0
14	37.30	32.5
15	39.80	35.0
16	42.30	37.5

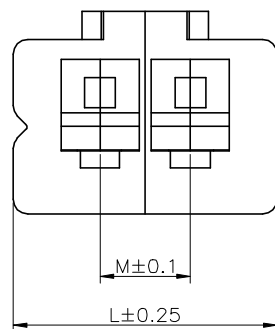
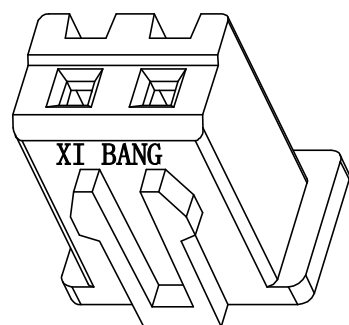

Ordering Information

XB-X25-PCB-105-A001M - XX A XX

No. of Pins
02-16

Materials /Color
P1=NY 66/White

东莞市溪榜电子有限公司 DONG GUAN XI BANG ELECTRONICS CO.,LTD				
REV.	UNIT.	SCALE.	PAGE.	
A	mm	1:1	1/1	
GENERAL TOLERANCE X.'± X.± .X'± .X±0.25 .XX'± .XX±0.15 .XXX'± .XXX±0.10				

DESIGNED:
 CHECKED:
 APPROVED:

DATE:
 DATE:
 DATE:

DWG. NO.
 XB-X25-PCB-105-A001M
 PART NO.

TITLE:
 2.5mm pitch housing

1 2 3 4 5 6 7 8 9

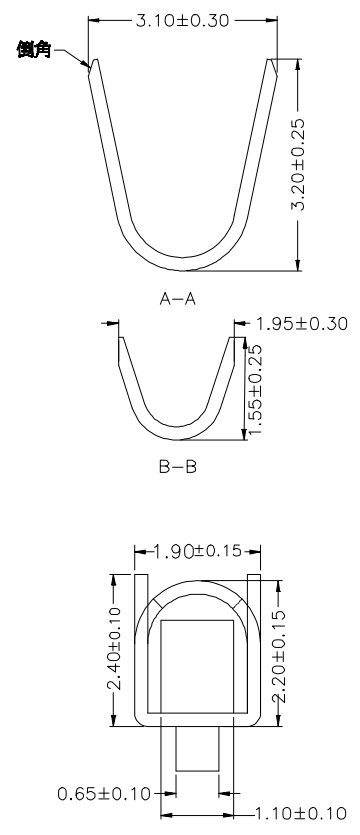
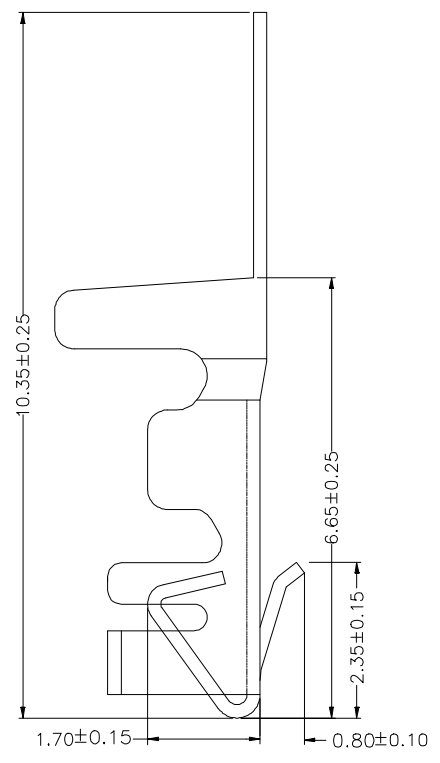
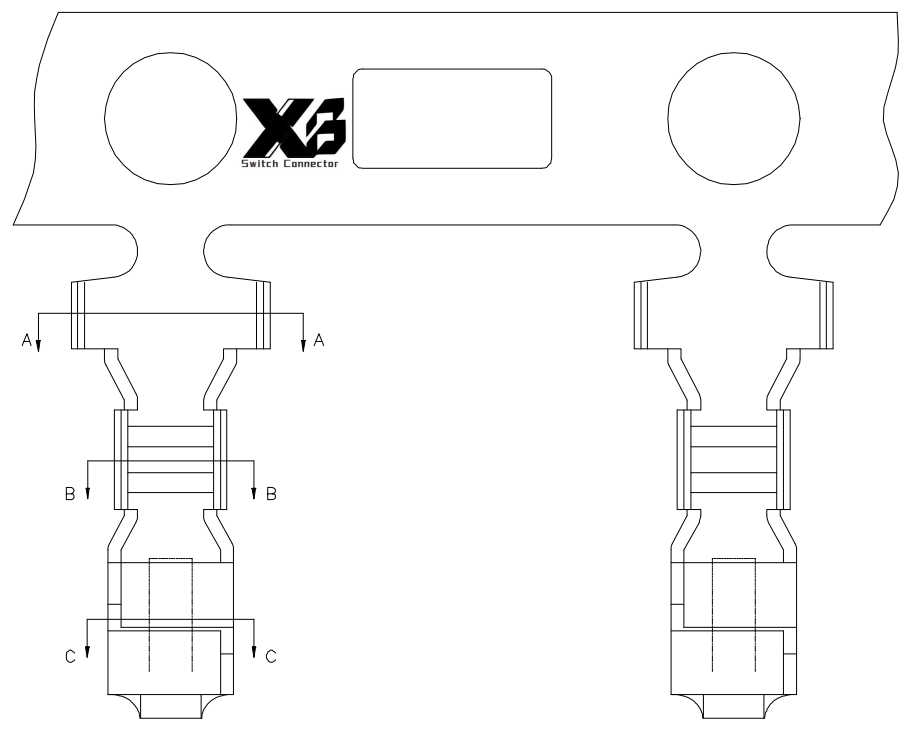

Contact Material: Phosphor Bronze
 Finish: See Part Number
 Wire range: AWG#22~28
 Insulation O.D: 1.9mm(max)
 Qty/Reel: 7000
 All materials must meet XI BANG
 hazardous substances control standards.

Ordering Information

XB-X25-PCB-105-A001D - 01 **XX** **XX**

Standard Plating Materials
 01= Tin AB= Phosphor Bronze
 02= Gold Flash

A	东莞市溪榜电子有限公司 DONG GUAN XI BANG ELECTRONICS CO., LTD		GENERAL TOLERANCE X.'± X.± .X'± .X±0.25 .XX'± .XX±0.15 .XXX'± .XXX±0.10		DESIGNED:	DATE:	DWG. NO. XB-X25-PCB-105-A001D	TITLE. 2.5mm pitch Terminal
	REV. B	UNIT. mm	SCALE. 1:1	PAGE. 1/1	CHECKED:	DATE:		
					APPROVED:	DATE:		