

NOTES:

CURRENT RATING:3A AC/DC.  
 VOLTAGE RATING:250V AC/DC  
 TEMPERATURE RANGE:-40°C~+105°C.  
 CONTACT RESISTANCE:10mΩ Max.  
 INSULATION RESISTANCE:1000MΩ Min.  
 WITHSTANDING VOLTAGE: 800V AC/MINUTE.

MATERIAL:

HOUSING:LCP UL94V-0  
 CONTACT: COPPER ALLOY

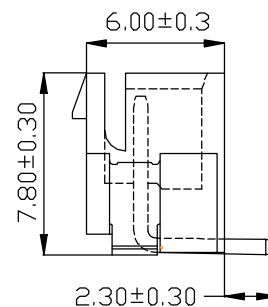
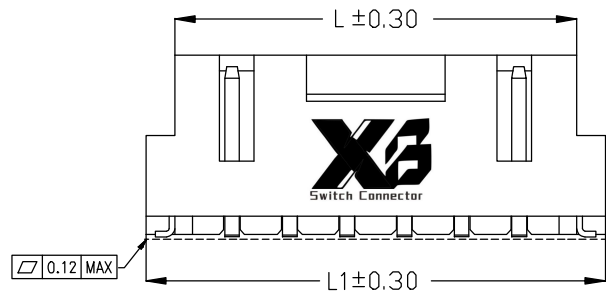

No. of pin/row	Dimensions(mm)		
	M	L	L1
02	2.50	7.50	10.00
03	5.00	10.00	12.50
04	7.50	12.50	15.00
05	10.00	15.00	17.50
06	12.50	17.50	20.00
07	15.00	20.00	22.50
08	17.50	22.50	25.00
09	20.00	25.00	27.50
10	22.50	27.50	30.00
11	25.00	30.00	32.50
12	27.50	32.50	35.00
13	30.00	35.00	37.50
14	32.50	37.50	40.00
15	35.00	40.00	42.50
16	37.50	42.50	45.00

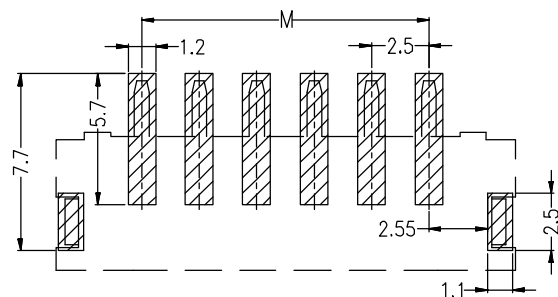

PCB LAYOUT

Ordering Information

XB-X25-PCB-104-A002 XX A 002 C X B X

No. of Pins per Row 02~16      Standard Plating 01=Tin      Color 1=Black 2=White ...      Standard Packing D=Tape&Reel Selective Packing B=Tray ...

Selective Plating 02=Gold Flash 22=Matte Tin ...

东莞市溪榜电子有限公司 DONG GUAN XI BANG ELECTRONICS CO., LTD	3RD.ANG PROJ.	GENERAL TOLERANCE		DESIGNED:	DATE:	DWG. NO.	TITLE. 2.50mm pitch wafer SMT
	PAGE. 1/1	X. ± 3.0'	X. ± /	CHECKED:  APPROVED:	DATE:	XB-X25-PCB-104-A002	
		.X' ± 2.0'	.X ± 0.30			PART NO.	
		.XX' ± 1.5'	.XX ± 0.25				
REV. A	UNIT. mm	SCALE. 1:1	.XXX' ± 1.0'	.XXX ± 0.15	DATE:		

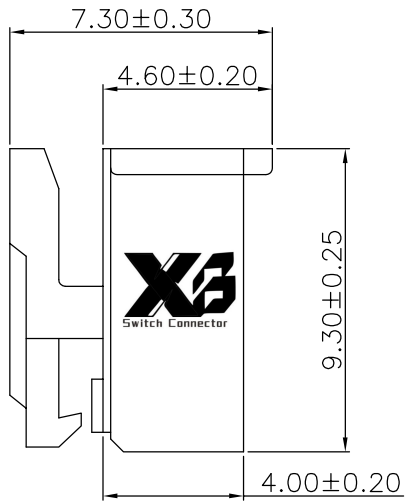
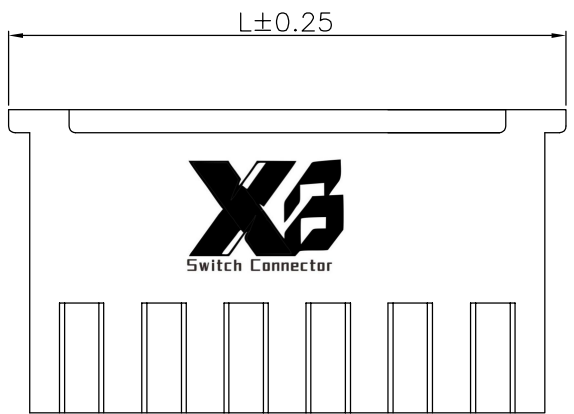

**Specifications**  
 Current Rating: 3A  
 Voltage Rating: 250V  
 Insulation Resistance: 1000MΩ Min.  
 Dielectric Withstanding Voltage: 100VAC  
 Contact Resistance: 20mΩ Max.  
 Operating Temperature: -25°C to +105°C  
**Materials**  
 Insulator Material: Nylon-66, UL94V-0  
 Mating With:  
 Terminal: GRG115-T1  
 Wafer: GWGB102-805/GWGD105-A002  
 All materials must meet **XI BANG**  
 hazardous substances control standards.

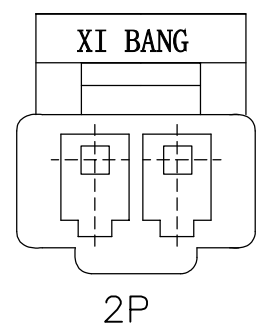
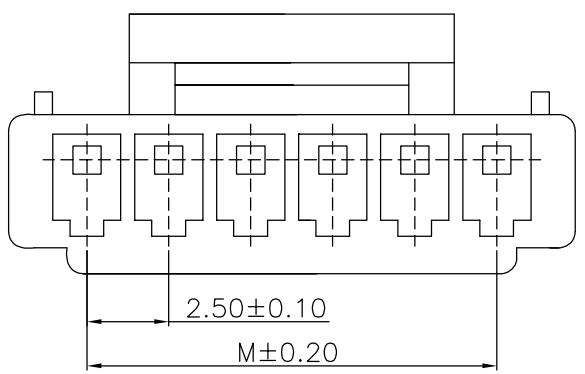

### Ordering Information

XB-X25-PCB-104-A002M- XX A XX  
 No. of Pins SEE TABLE  
 Materials /Color P1=NY66/White

No. of Pins/Row	Dimension Information	
	M	L
02	2.50	6.80
03	5.00	9.30
04	7.50	11.80
05	10.00	14.30
06	12.50	16.80
07	15.00	19.30
08	17.50	21.80
09	20.00	24.30
10	22.50	26.80
11	25.00	29.30
12	27.50	31.80
20	47.50	59.30

**东莞市溪榜电子有限公司**  
 DONG GUAN XI BANG ELECTRONICS CO., LTD

REV. A UNIT. mm SCALE. 1:1

3RD. ANG PROJ.  
 PAGE. 1/1

GENERAL TOLERANCE	
X.*±5.0*	X.±/
.X*±3.0*	.X±0.25
.XX*±2.0*	.XX±0.15
.XXX*±1.0*	.XXX±0.10

DESIGNED:  
 CHECKED:  
 APPROVED:

DATE:  
 DATE:  
 DATE:

DWG. NO.  
 XB-X25-PCB-104-A002M  
 PART NO.

TITLE.  
 2.50mm Pitch Housing

1 2 3 4 5 6 7 8 9

F

E

D

C

B

A

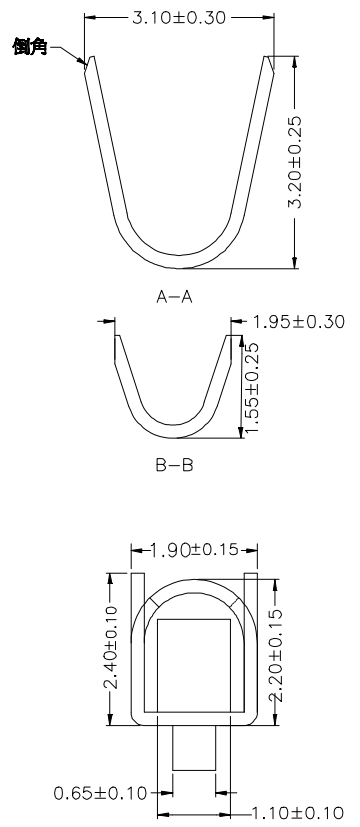
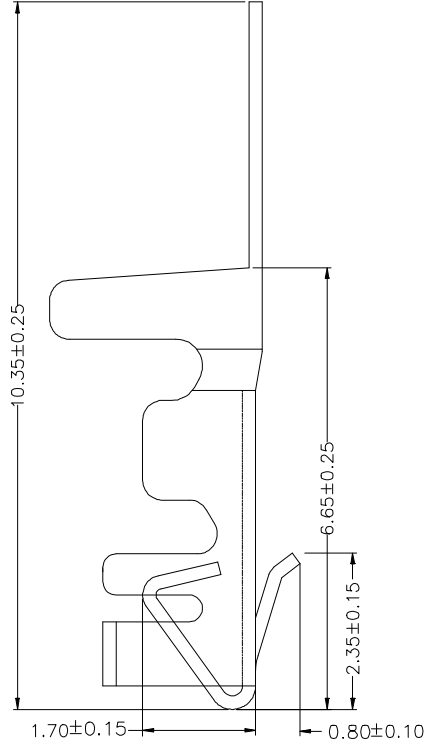
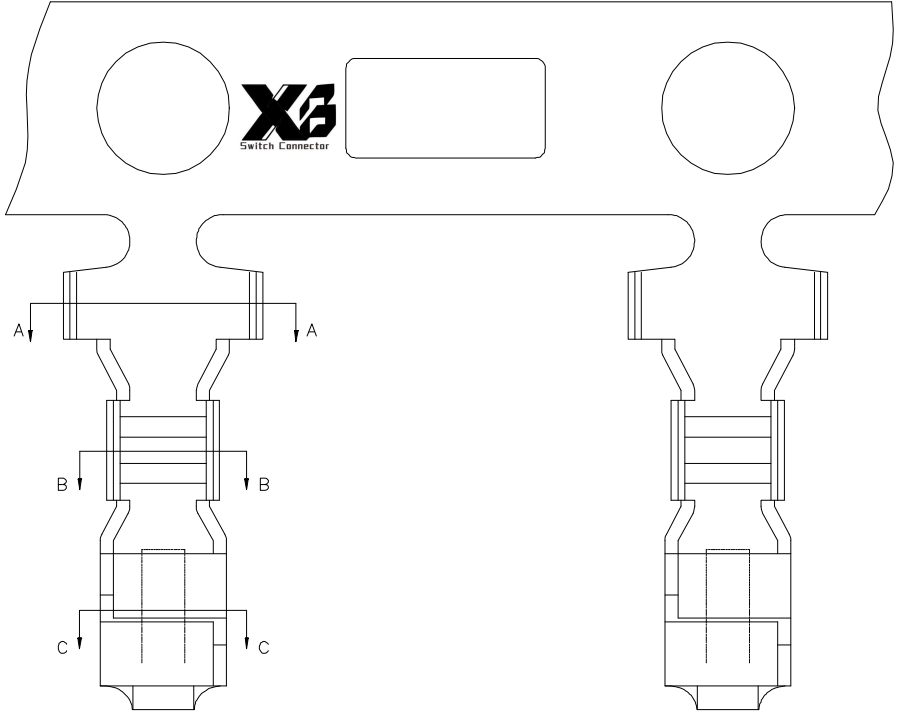

Contact Material: Phosphor Bronze  
 Finish: See Part Number  
 Wire range: AWG#22~28  
 Insulation O.D: 1.9mm(max)  
 Qty/Reel: 7000  
 All materials must meet XI BANG  
 hazardous substances control standards.

### Ordering Information

**XB-X25-PCB-104-A002D** **XX** **XX**

Standard Plating: 01=Tin, 02=Gold Flash  
 Materials: AB=Phosphor Bronze

<b>东莞市溪榜电子有限公司</b> DONG GUAN XI BANG ELECTRONICS CO., LTD	GENERAL TOLERANCE		DESIGNED:	DATE:	DWG. NO.	TITLE.				
	X.*±	X.±					CHECKED:	DATE:	XB-X25-PCB-104-A002D	2.5mm pitch Terminal
	.X*±	.X±0.25								
	.XX*±	.XX±0.15								
	.XXX*±	.XXX±0.10								
APPROVED:	DATE:	PART NO.								
REV. B	UNIT. mm	SCALE. 1:1	PAGE. 1/1							

9B

1 2 3 4 5 6 7 8 9

F

E

D

C

B

A