

1 2 3 4 5 6 7 8 9

F

F

E

E

D

D

C

C

B

B

A

A

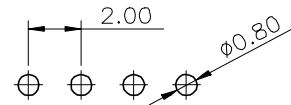
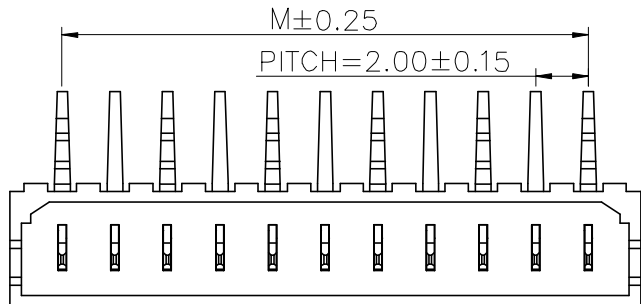

Recommended P.C.B Layout

NOTES:

CURRENT RATING:2A AC/DC.
VOLTAGE RATING:125V AC/DC
TEMPERATURE RANGE:-40°C~+105°C.
CONTACT RESISTANCE:20mΩ Max.
INSULATION RESISTANCE:1000MΩ Min.
WITHSTANDING VOLTAGE: 800V AC/MINUTE.
MATERIAL:PA66 UL94V-0.

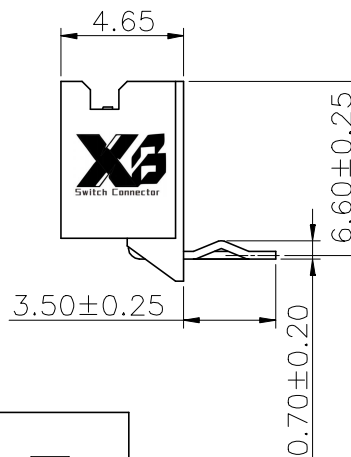
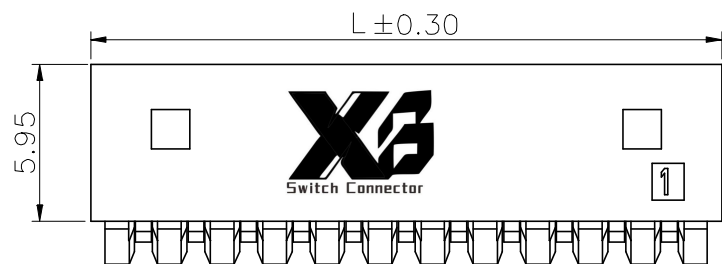

No. of Pin/Row	DIMENSION	
	M	L
02	2.00	6.00
03	4.00	8.00
04	6.00	10.00
05	8.00	12.00
06	10.00	14.00
07	12.00	16.00
08	14.00	18.00
09	16.00	20.00
10	18.00	22.00
11	20.00	24.00
12	22.00	26.00
13	24.00	28.00
14	26.00	30.00
15	28.00	32.00

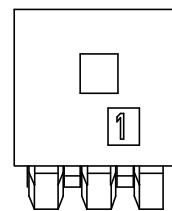
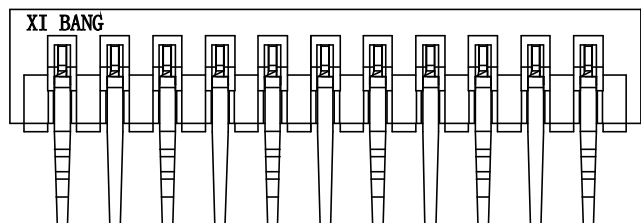

XB-X20-PCB-123-A002

Ordering Information



XB 东莞市溪榜电子有限公司
DONG GUAN XI BANG ELECTRONICS CO., LTD

3RD.ANG PROJ.

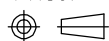

PAGE. 1/1

GENERAL TOLERANCE

X.'±5.0'	X.±/
.X'±3.0'	.X±0.30
.XX'±2.0'	.XX±0.20
.XXX'±1.0'	.XXX±0.15

DESIGNED:

DATE:

DWG. NO.

XB-X20-PCB-123-A002

TITLE.

PITCH 2.0mm 90° WAFER

CHECKED:

DATE:

PART NO.

APPROVED:

DATE:

REV. A	UNIT. mm	SCALE. 1:1
--------	----------	------------

1 2 3 4 5 6 7 8 9

1 2 3 4 5 6 7 8 9

F

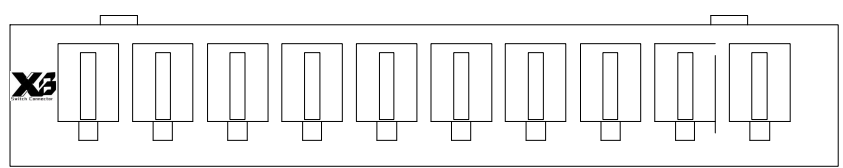

NOTES:
 CURRENT RATING:2A AC/DC.
 VOLTAGE RATING:125V AC/DC
 TEMPERATURE RANGE:-40°C~+105°C.
 CONTACT RESISTANCE:20MΩ Max.
 INSULATION RESISTANCE:1000MΩ Min.
 WITHSTANDING VOLTAGE: 800V AC/MINUTE.
 MATERIAL:PA66.UL94V-0.

E

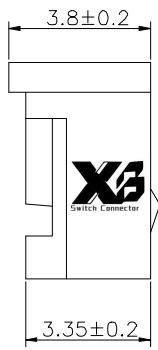
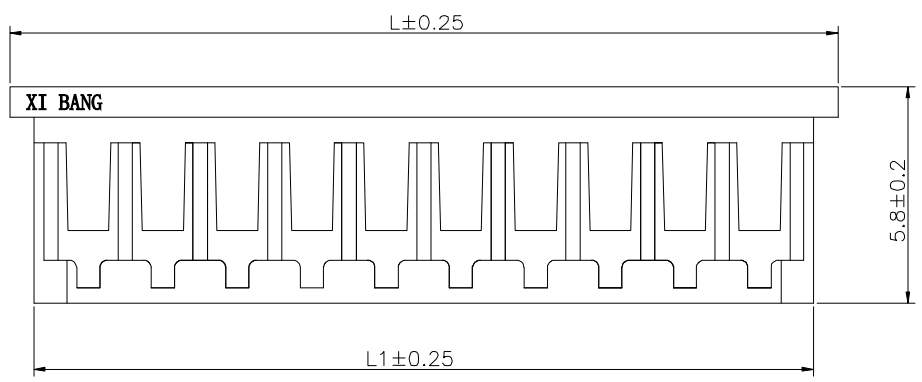

D

C

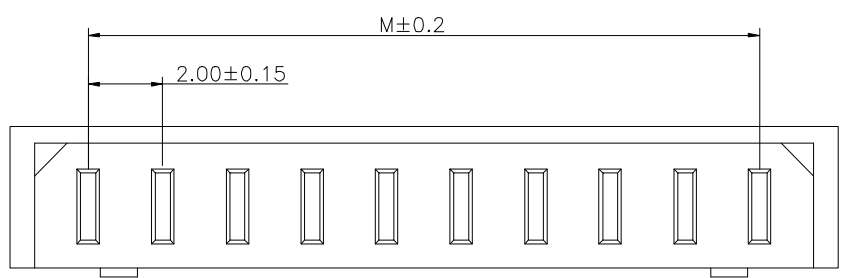

Ordering Information

XX A X
 No. of Pins/Row 02~15
 Material/Color P1=Nylon 66/White

PART NO.	DIMENSION		
	M	L1	L
02P	2.00	4.90	6.10
03P	4.00	6.90	8.10
04P	6.00	8.90	10.10
05P	8.00	10.90	12.10
06P	10.00	12.90	14.10
07P	12.00	14.90	16.10
08P	14.00	16.90	18.10
09P	16.00	18.90	20.10
10P	18.00	20.90	22.10
11P	20.00	22.90	24.10
12P	22.00	24.90	26.10
13P	24.00	26.90	28.10
14P	26.00	28.90	30.10
15P	28.00	30.90	32.10

B

A

东莞市溪榜电子有限公司 DONG GUAN XI BANG ELECTRONICS CO., LTD	GENERAL TOLERANCE		DESIGN:	DATE:	DWG. NO.	TITLE. 2.0mm pitch housing
	X.'±5.0'	X.±	CHECKED:	DATE:	XB-X20-PCB-123-A002M	
	.X'±3.0'	.X±0.50	AUDITED:	DATE:	PART NO.	
	.XX'±2.0'	.XX±0.25				
	.XXX'±1.0'	.XXX±0.10				

1 2 3 4 5 6 7 8 9

1 2 3 4 5 6 7 8 9

F

F

E

E

D

D

C

C

B

B

A

A

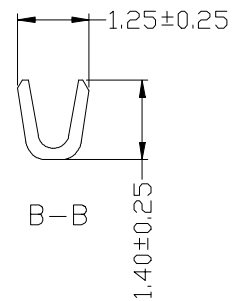
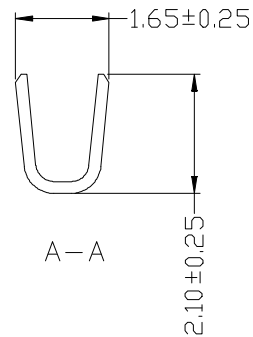
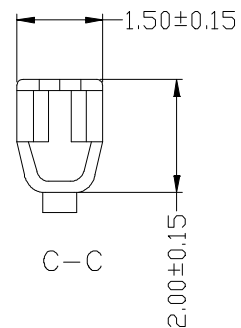
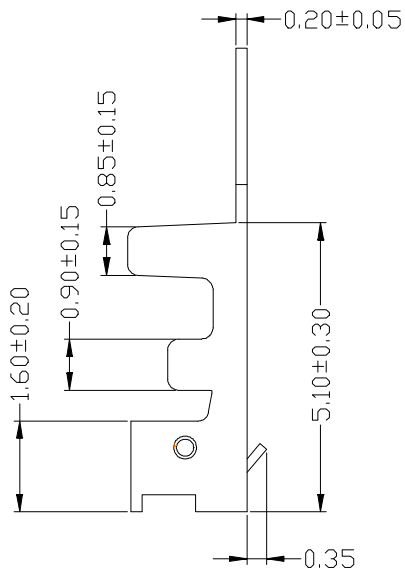
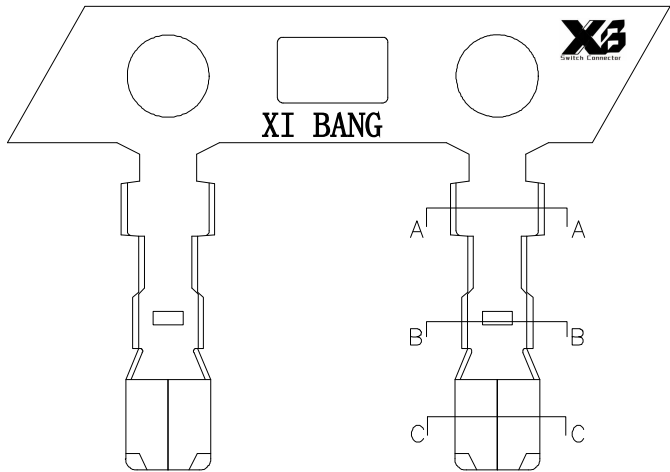

Ordering Information

XB-X20-PCB-123-A002D XX

XX

Standard Plating
01=Tin

Materials
AB=Phosphor bronze

Wire range	Insulation O.D.	Materials	Finish	Qty/re
AWG#26-28	1.4mm(max)	Phosphor Bronze	Tin-plated	10000

东莞市溪榜电子有限公司 DONG GUAN XI BANG ELECTRONICS CO., LTD	GENERAL TOLERANCE		DESIGN:	DATE:	DWG. NO.	TITLE.
	X:±3.0'	X.±/	AUDITED:	DATE:	XB-X20-PCB-123-A002D	
	.X'±2.0'	.X±0.25	APPROVED:	DATE:	PART NO.	
	.XX'±1.0'	.XX±0.15				
REV. B	UNIT. mm	SCALE. 8:1	PAGE. 1/1			2.00mm Pitch Terminal

1 2 3 4 5 6 7 8 9