

Specifications  
 Current Rating: 3A AC/DC  
 Voltage Rating : 125V AC/DC  
 Insulation Resistance: 1000MΩ Min.  
 Dielectric Withstanding Voltage: 500V AC/Minute  
 Contact Resistance: 20mΩ Max.  
 After environmental testing: 30mΩ Max  
 Temperature Range: -40°C to +105°C  
 Materials  
 Contact Material: Phosphor Bronze  
 Insulator Material: PA66 94V-0  
 All materials must meet XI BANG hazardous substances control standards.

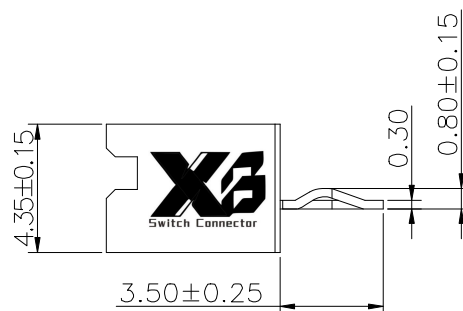

Recommended P.C.Board Layout  
 (Tolerance: ±0.05)

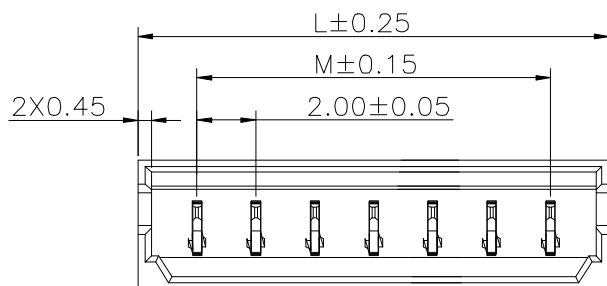
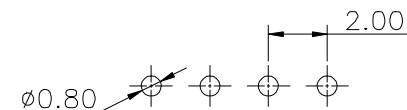

## Ordering Information

XB-X20-PCB-114-A800 XX XX A 800 E 5 S X

No. of Pins per Row 02~15  
 Standard Plating 01=Tin 22=Matte Tin  
 Material E=Nylon 66  
 Color 5=Biege  
 Standard Packing N=PE Bag

No. of PIN/ROW	Dimension Information	
	M	L
02	2.00	6.00
03	4.00	8.00
04	6.00	10.00
05	8.00	12.00
06	10.00	14.00
07	12.00	16.00
08	14.00	18.00
09	16.00	20.00
10	18.00	22.00
11	20.00	24.00
12	22.00	26.00
13	24.00	28.00
14	26.00	30.00
15	28.00	32.00

**XB** 东莞市溪榜电子有限公司  
 DONG GUAN XI BANG ELECTRONICS CO., LTD

REV. 01 UNIT. mm SCALE. 4:1 PAGE. 1/1

GENERAL TOLERANCE	
X.'±5.0'	X.±0.30
.X'±3.0'	.X±0.25
.XX'±2.0'	.XX±0.15
.XXX'±1.0'	.XXX±0.10

DESIGNED:  
 CHECKED:  
 CO SIGEND:  
 APPROVED:

DATE:  
 DATE:  
 DATE:  
 DATE:

DWG. NO.  
 XB-X20-PCB-114-A800  
 PART NO.

TITLE.  
 2.0 mm Crimp Style connectors

1 2 3 4 5 6 7 8 9

F

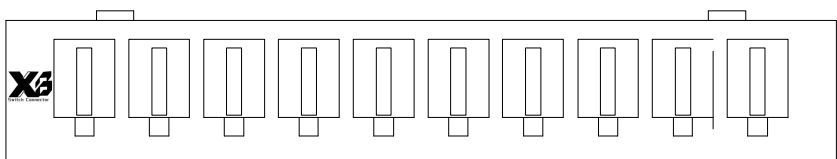

E

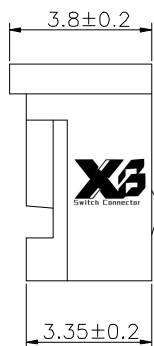
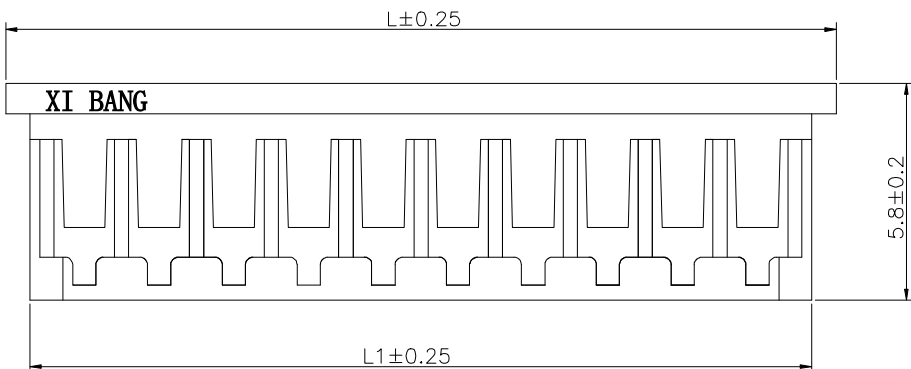

NOTES:

CURRENT RATING:2A AC/DC.  
 VOLTAGE RATING:125V AC/DC  
 TEMPERATURE RANGE:-40°C~+105°C.  
 CONTACT RESISTANCE:20MΩ Max.  
 INSULATION RESISTANCE:1000MΩ Min.  
 WITHSTANDING VOLTAGE: 800V AC/MINUTE.  
 MATERIAL:PA66.UL94V-0.

D

C

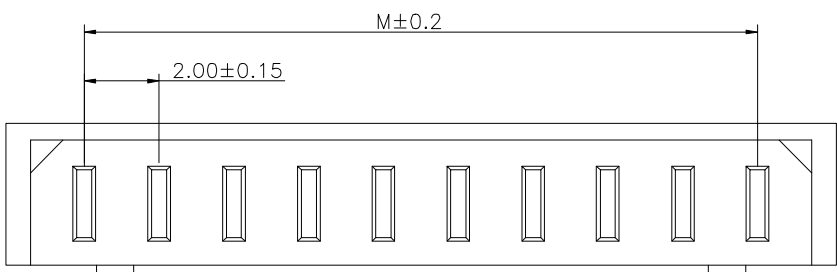

B

**Ordering Information**

XX A X  
 No. of Pins/Row Material/Color  
 02-15 P1=Nylon 66 /White

PART NO.	DIMENSION		
	M	L1	L
02P	2.00	4.90	6.10
03P	4.00	6.90	8.10
04P	6.00	8.90	10.10
05P	8.00	10.90	12.10
06P	10.00	12.90	14.10
07P	12.00	14.90	16.10
08P	14.00	16.90	18.10
09P	16.00	18.90	20.10
10P	18.00	20.90	22.10
11P	20.00	22.90	24.10
12P	22.00	24.90	26.10
13P	24.00	26.90	28.10
14P	26.00	28.90	30.10
15P	28.00	30.90	32.10

A

**XI BANG** 东莞市溪榜电子有限公司  
 DONG GUAN XI BANG ELECTRONICS CO., LTD

REV. A UNIT. mm SCALE. 1:1 PAGE. 1/1

GENERAL TOLERANCE	
X.*±5.0*	X.±
.X*±3.0*	.X±0.50
.XX*±2.0*	.XX±0.25
.XXX*±1.0*	.XXX±0.10

DESIGN:  
 CHECKED:  
 AUDITED:

DATE:  
 DATE:  
 DATE:

DWG. NO.  
 XB-X20-PCB-114-A800M  
 PART NO.

TITLE.  
 2.0mm pitch housing

1 2 3 4 5 6 7 8 9

F

E

D

C

B

A

1 2 3 4 5 6 7 8 9

F

E

D

C

B

A

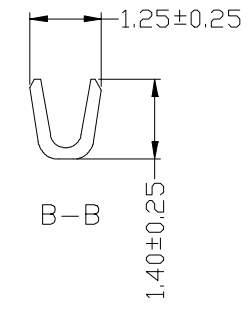
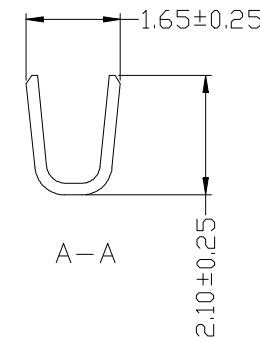
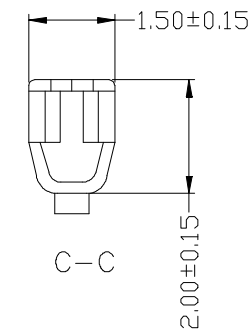
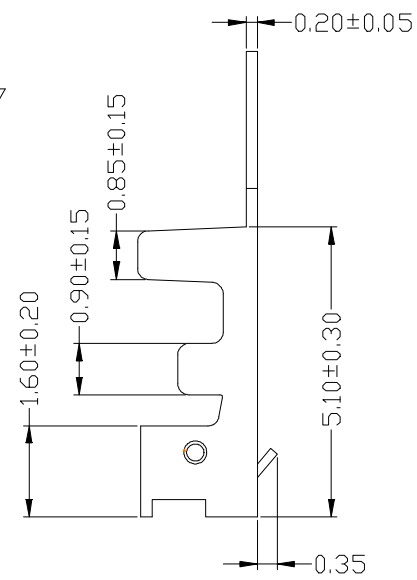
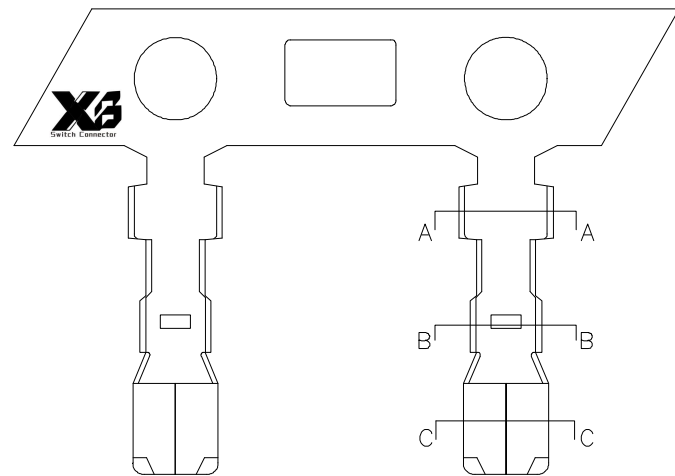

### Ordering Information

**XB-X20-PCB-114-A800D XX XX**

Standard Plating  
01=Tin

Materials  
AB=Phosphor bronze

Wire range	Insulation O.D.	Materials	Finish	Qty/re
AWG#26-28	1.4mm(max)	Phosphor Bronze	Tin-plated	10000

<b>东莞市溪榜电子有限公司</b> DONG GUAN XI BANG ELECTRONICS CO., LTD	GENERAL TOLERANCE		DESIGN:	DATE:	DWG. NO.	TITLE.
	<b>X'±3.0'</b>	X.±/	AUDITED:	DATE:	XB-X20-PCB-114-A800D	
	<b>.X'±2.0'</b>	.X±0.25	APPROVED:	DATE:	PART NO.	2.00mm Pitch Terminal
	<b>.XX'±1.0'</b>	.XX±0.15				
REV. B	UNIT. mm	SCALE. 8:1	PAGE. 1/1			
<b>.XXX'±0.5'</b>	.XXX±0.10					

1 2 3 4 5 6 7 8 9