

1 2 3 4 5 6 7 8 9

F

E

D

C

B

A

F

E

D

C

B

A

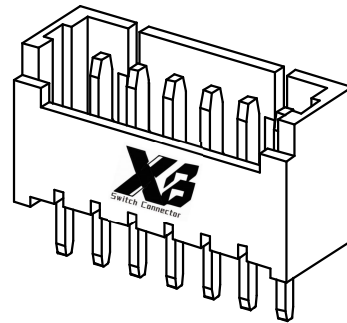
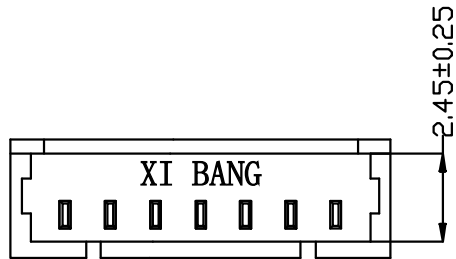

Specifications:
 Current rating:1A AC/DC.
 Voltage rating:125V AC/DC
 Temperature range:-40°C~+105°C.
 Contact resistance:20MΩ Max.
 Insulation resistance:100MΩ Min.
 Withstanding voltage: 500V AC/minute.
 Material:PA46.UL94V-0.

No of PIN/Row	Dimensions	
	M	L
02	1.25	4.25
03	2.50	5.50
04	3.75	6.75
05	5.00	8.00
06	6.25	9.25
07	7.50	10.50
08	8.75	11.75
09	10.00	13.00
10	11.25	14.25
11	12.50	15.50
12	13.75	16.75
13	15.00	18.00
14	16.25	19.25
15	17.50	20.50
16	18.75	21.75

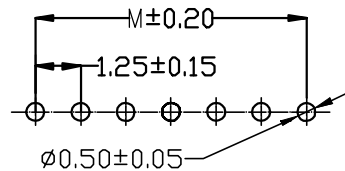
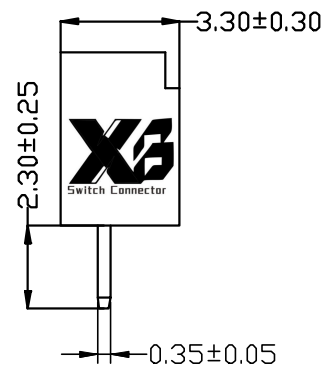
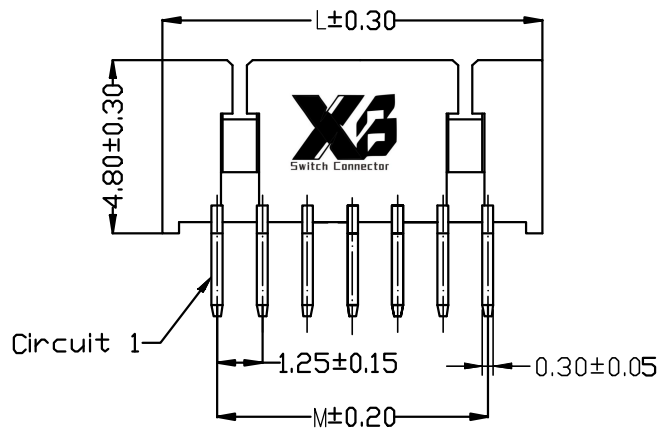

PCB LAYOUT

Ordering Information

XB-X125-PCB-L-106 XX XX A 001 F X B X

No. of Pins per Row 02~16 Standard Plating 01=Tin
 Selective Plating 02=Gold Flash
 05=Gold Flash/Tin

Color 2=White ... Standard Packing N=PE Bag

东莞市溪榜电子有限公司
 DONG GUAN XI BANG ELECTRONICS CO., LTD

3RD.ANG PROJ.
 PAGE. 1/1

GENERAL TOLERANCE	
X.±3.0°	X.±/
.X'±2.0°	.X±0.30
.XX'±1.5°	.XX±0.25
.XXX'±1.0°	.XXX±0.15

DESIGNED: DATE: DWG. NO.
 CHECKED: DATE: XB-X125-PCB-L-106
 APPROVED: DATE: PART NO.

TITLE.
 1.25 Pitch Wafer

REV. A UNIT. mm SCALE. 1:1

1 2 3 4 5 6 7 8 9

1 2 3 4 5 6 7 8 9

F

F

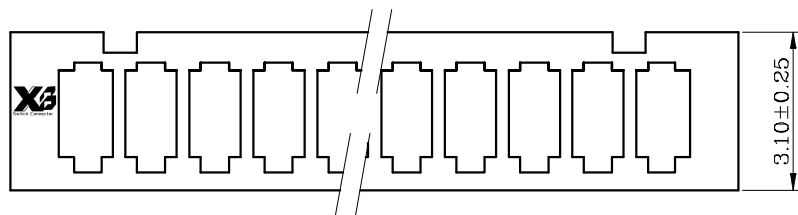

NOTES:

CURRENT RATING:1A AC/DC.
 VOLTAGE RATING:125V AC/DC
 TEMPERATURE RANGE:-40°C~+105°C.
 CONTACT RESISTANCE:20MΩ Max.
 INSULATION RESISTANCE:100MΩ Min.
 WITHSTANDING VOLTAGE:500V AC/MINUTE.
 MATERIAL:NYLON 66.UL94V-0.

E

E

D

D

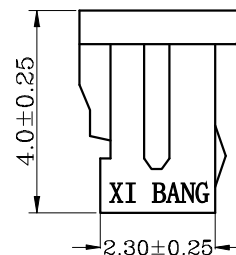
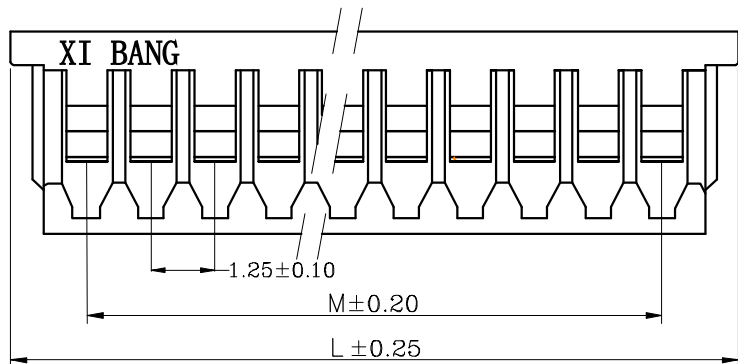

No of Pin/Row	Dimensions	
	M	L
02	1.25	4.25
03	2.50	5.50
04	3.75	6.75
05	5.00	8.00
06	6.25	9.25
07	7.50	10.50
08	8.75	11.75
09	10.00	13.00
10	11.25	14.25
11	12.50	15.50
12	13.75	16.75
13	15.00	18.00
14	16.25	19.25
15	17.50	20.50
16	18.75	21.75

C

C

B

B

XB-X125-PCB-L-106M - XX A X

No. of Pin/Row
02 ~ 16

Material/Color
M=Nylon66/White

A

A

XB 东莞市溪榜电子有限公司
 DONG GUAN XI BANG ELECTRONICS CO.,LTD

3RD.ANG PROJ.

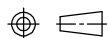

PAGE. 1/1

GENERAL TOLERANCE

X.' ± 5.0'	X. ±
.X' ± 3.0'	.X ± 0.30
.XX' ± 2.0'	.XX ± 0.25
.XXX' ± 1.0'	.XXX ± 0.15

DESIGNED:

DATE:

CHECKED:

DATE:

APPROVED:

DATE:

DWG. NO.

XB-X125-PCB-L-106M

PART NO.

TITLE.

1.25mm pitch housing

REV. A UNIT. mm SCALE. 1:1

1 2 3 4 5 6 7 8 9

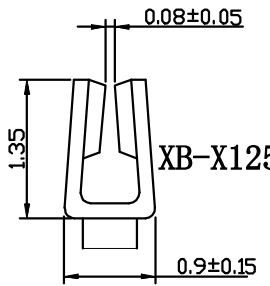
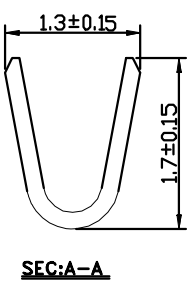
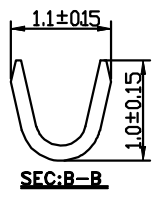
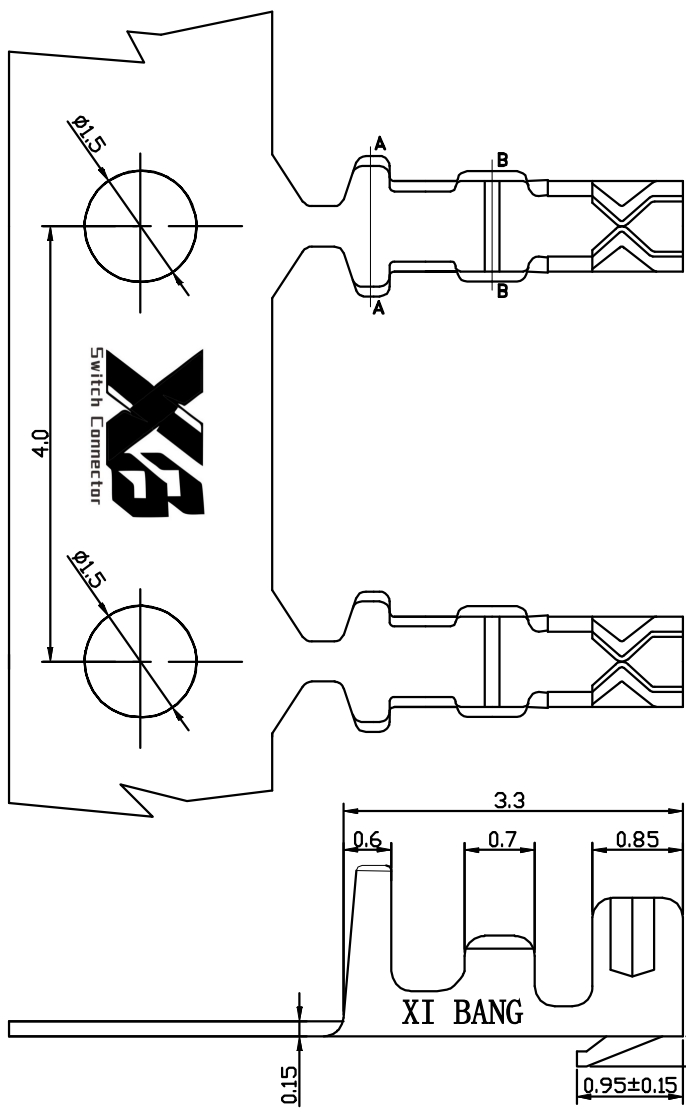

Specifications:
 1. Material: Phosphor Bronze
 2. Wire Range: AWG#28-32
 3. Insulation O. D. : 1.0mm(Max)

Ordering Information

XB-X125-PCB-L-106- 01 XX AB
 Standard Plating 01=Tin Materials AB=Phosphor bronze

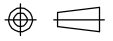
3RD.ANG PROJ. 	GENERAL TOLERANCE X.停 / X.?		DESIGNED:	DATE:	DWG. NO.	TITLE.	
	.X停 / .X?.30		CHECKED:	DATE:			
	.XX停 / .XX?.25		APPROVED:	DATE:	PART NO.		
	.XXX停 / .XXX?. 15						
REV. A	UNIT. mm	SCALE. 1:1	PAGE. 1/1				1.25mm Pitch terminal