

**Specifications:**  
 Current rating:1A AC/DC.  
 Voltage rating:125V AC/DC  
 Temperature range:-40°C~+105°C.  
 Contact resistance:20mΩ Max.  
 Insulation resistance:100MΩ Min.  
 Withstanding voltage: 500V AC/minute.  
 Material:PA46 .UL94V-0.

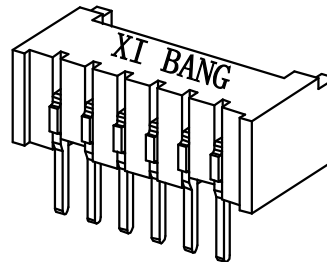

No of PIN/Row	Dimensions	
	M	L
02	1.25	4.25
03	2.50	5.50
04	3.75	6.75
05	5.00	8.00
06	6.25	9.25
07	7.50	10.50
08	8.75	11.75
09	10.00	13.00
10	11.25	14.25
11	12.50	15.50
12	13.75	16.75
13	15.00	18.00
14	16.25	19.25
15	17.50	20.50
16	18.75	21.75

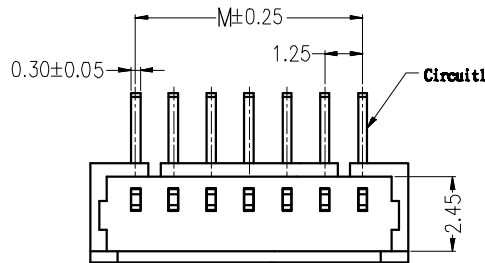
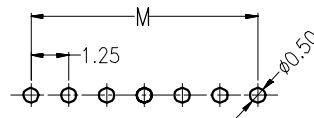
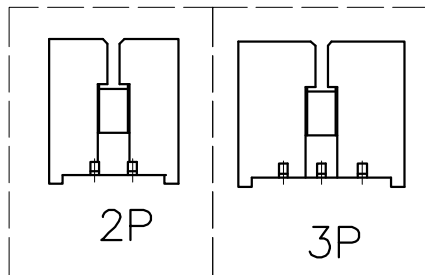

RECOMMENDED PCB LAYOUT

### Ordering Information

XB-X125-PCB-112-XX XX A 001 F X B X

No. of Pins per Row 02~16      Standard Plating 01=Tin Selective Plating 02=Gold Flash      Color 1=BLACK 2=White ...      Standard Packing N=PE Bag

**XB** 东莞市溪榜电子有限公司  
 DONG GUAN XI BANG ELECTRONICS CO., LTD

3RD.ANG  
 PROJ.

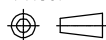

PAGE.  
 1/1

GENERAL TOLERANCE

X.*±3.0"	X.±/
.X*±2.0"	.X±0.30
.XX*±1.5"	.XX±0.25
.XXX*±1.0"	.XXX±0.15

DESIGNED:

DATE:

CHECKED:

DATE:

APPROVED:

DATE:

DWG. NO.

XB-X125-PCB-112

PART NO.

TITLE.

1.25 Pitch 90°Wafer

REV. A      UNIT. mm      SCALE. 1:1

1 2 3 4 5 6 7 8 9

F

F

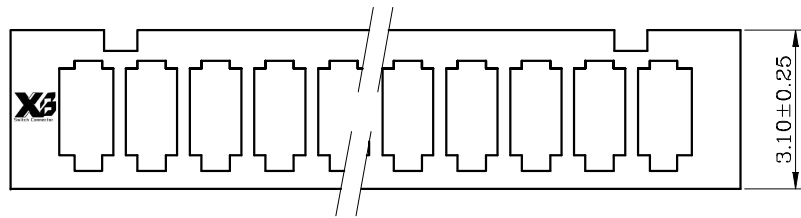

**NOTES:**

CURRENT RATING:1A AC/DC.  
 VOLTAGE RATING:125V AC/DC  
 TEMPERATURE RANGE:-40°C~+105°C.  
 CONTACT RESISTANCE:20MΩ Max.  
 INSULATION RESISTANCE:100MΩ Min.  
 WITHSTANDING VOLTAGE:500V AC/MINUTE.  
 MATERIAL:NYLON 66.UL94V-0.

E

E

D

D

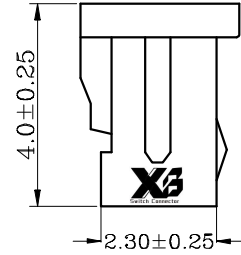
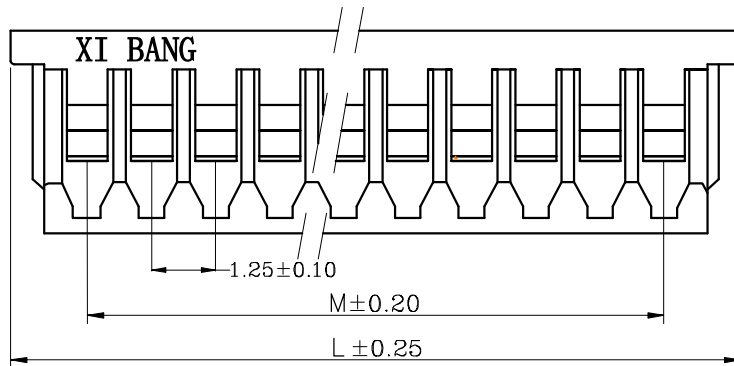

No of Pin/Row	Dimensions	
	M	L
02	1.25	4.25
03	2.50	5.50
04	3.75	6.75
05	5.00	8.00
06	6.25	9.25
07	7.50	10.50
08	8.75	11.75
09	10.00	13.00
10	11.25	14.25
11	12.50	15.50
12	13.75	16.75
13	15.00	18.00
14	16.25	19.25
15	17.50	20.50
16	18.75	21.75

C

C

B

B

**XB-X125-PCB-112M - XX A X**  
 No. of Pin/Row: 02 ~ 16  
 Material/Color: M=Nylon66/White

A

A

东莞市溪榜电子有限公司 DONG GUAN XI BANG ELECTRONICS CO., LTD	3RD.ANG PROJ.	GENERAL TOLERANCE		DESIGNED:	DATE:	DWG. NO. XB-X125-PCB-112M	TITLE. 1.25mm pitch housing			
		X:±5.0'	X,±					CHECKED:	DATE:	PART NO.
		.X'±3.0'	.X±0.30							
REV. A	UNIT. mm	SCALE. 1:1	PAGE. 1/1							

1 2 3 4 5 6 7 8 9

1 2 3 4 5 6 7 8 9

F  
E  
D  
C  
B  
A

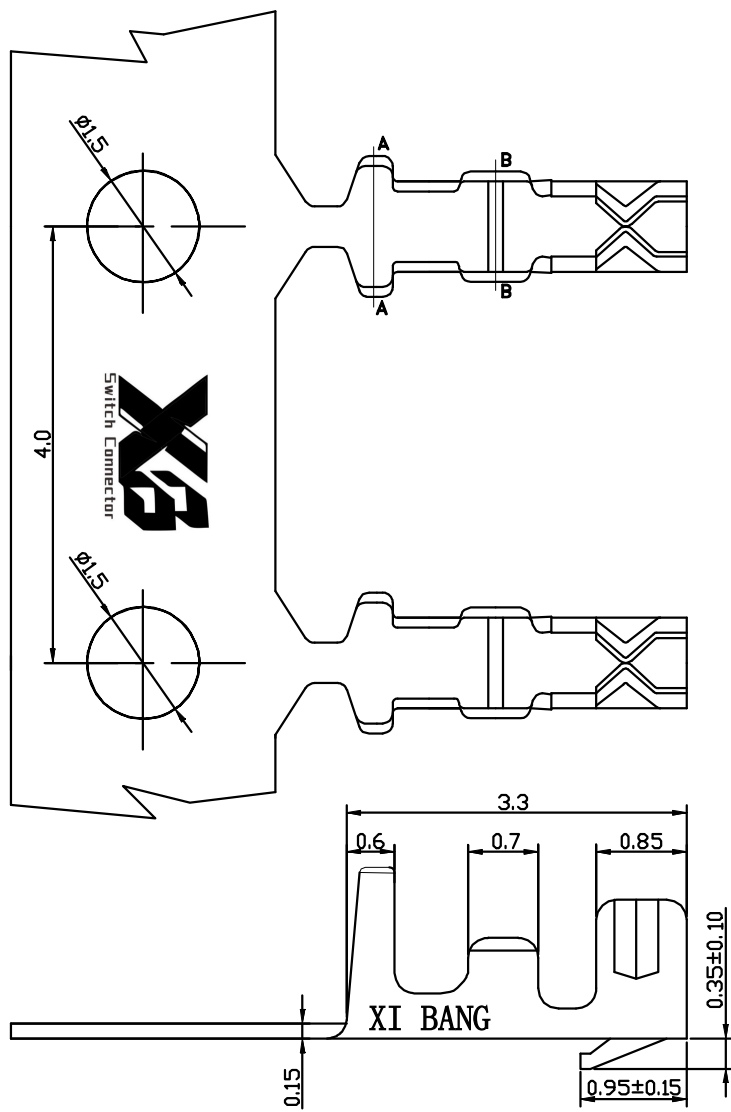

**Specifications:**  
**1. Material: Phosphor Bronze**  
**2. Wire Range: AWG#28-32**  
**3. Insulation O. D. : 1.0mm(Max)**

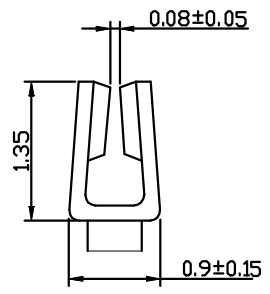
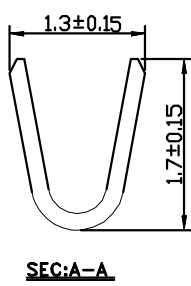
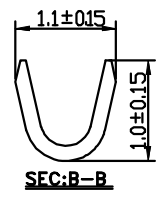

**Ordering Information**

**XB-X125-PCB-112D- XX AB**

Standard Plating  
01= Tin

Materials  
AB= Phosphor bronze

东莞市溪榜电子有限公司 DONG GUAN XI BANG ELECTRONICS CO., LTD	3RD.ANG PROJ.	GENERAL TOLERANCE		DESIGNED:	DATE:	DWG. NO.	TITLE.
		X. 棒 /	X. ?	CHECKED:	DATE:	XB-X125-PCB-112D	
REV. A	UNIT. mm	SCALE. 1:1	PAGE. 1/1	.X 棒 /	.X ? .30	PART NO.	1.25mm Pitch terminal
				.XX 棒 /	.XX ? .25		
				.XXX 棒 /	.XXX ? .15		

1 2 3 4 5 6 7 8 9