

1 2 3 4 5 6 7 8 9

F

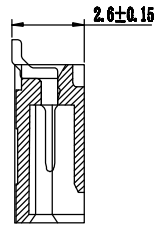
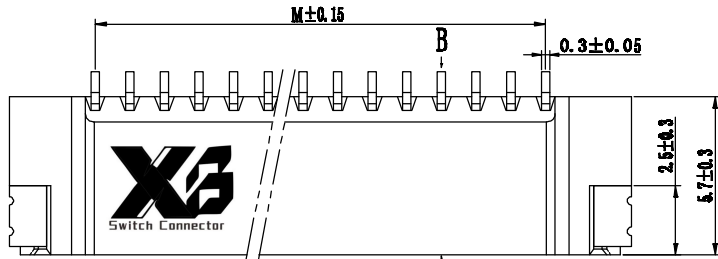

B-B

Specifications

Voltage Rating:200V AC/DC
 Current Rating:1.5Amp(AWG#26)
 Withstanding Volatge:1000V AC/minute
 Operating Temperature:-25°C to +85°C
 Insulation Resistance:1000MΩ Min.
 Contact Resistance:30mΩ Max.
 Material;
 Contact Material:Phosphor Bronze
 Insulator Material: PA9T UL94V-0
 All materials must meet XI BANG
 hazardous substances control standards.

E



D

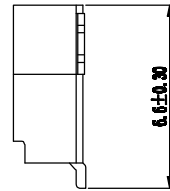
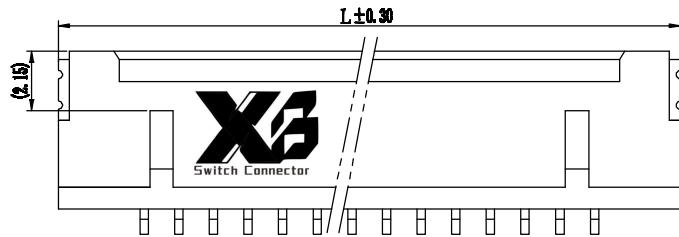

C

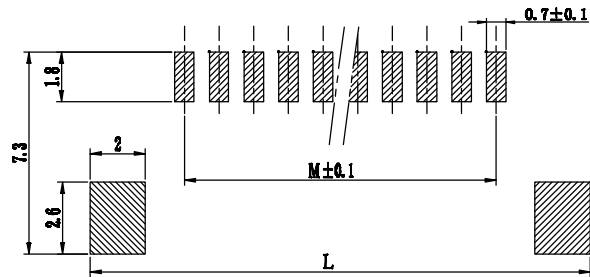

PCB Layout

| No of PIN/Row | Dimensions | | No of PIN/Row | Dimensions | |
|---------------|------------|-------|---------------|------------|-------|
| | M | L | | M | L |
| 3 | 2.5 | 8.7 | 17 | 20 | 26.2 |
| 4 | 3.75 | 9.95 | 18 | 21.25 | 27.45 |
| 5 | 5 | 11.2 | 19 | 22.5 | 28.7 |
| 6 | 6.25 | 12.45 | 20 | 23.75 | 29.95 |
| 7 | 7.5 | 13.7 | 21 | 25 | 31.2 |
| 8 | 8.75 | 14.95 | 22 | 26.25 | 32.45 |
| 9 | 10 | 16.2 | 23 | 27.5 | 33.7 |
| 10 | 11.25 | 17.45 | 24 | 28.75 | 34.95 |
| 11 | 12.5 | 18.7 | 25 | 30 | 36.2 |
| 12 | 13.75 | 19.95 | 26 | 31.25 | 37.45 |
| 13 | 15 | 21.2 | 27 | 32.5 | 38.7 |
| 14 | 16.25 | 22.45 | 28 | 33.75 | 39.95 |
| 15 | 17.5 | 23.7 | 29 | 35 | 41.2 |
| 16 | 18.75 | 24.95 | 30 | 36.25 | 42.45 |

B

Ordering Information

XB-X125-PCB-106 - XX XX A 002 D X A X

No. of Pins per Row
03~30

Standard Plating
02=Gold Flash
Selective Plating
01=Tin
22=Matte Tin

Color
2=White

Standard Packing
D=Tape&Reel

A

XB 东莞市溪榜电子有限公司
DONG GUAN XI BANG ELECTRONICS CO., LTD

3RD.ANG
PROJ.

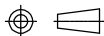

PAGE. 1/1

GENERAL TOLERANCE

| | |
|------------|-----------|
| X.±3.0' | X.±/ |
| .X'±2.0' | .X±0.25 |
| .XX'±1.5' | .XX±0.20 |
| .XXX'±1.0' | .XXX±0.10 |

DESIGNED:

DATE:

CHECKED:

DATE:

APPROVED:

DATE:

DWG. NO.

XB-X125-PCB-106

PART NO.

TITLE.

Pitch 1.25mm WTB 90° SMT
Single Row Right-Angle

| | | |
|--------|----------|------------|
| REV. A | UNIT. mm | SCALE. 1:1 |
|--------|----------|------------|

1 2 3 4 5 6 7 8 9

F

E

D

C

B

A

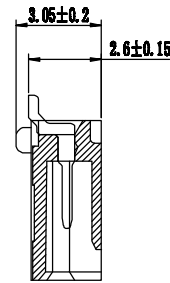
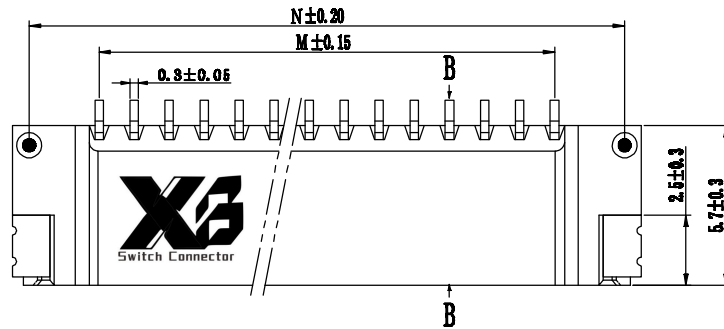

B-B

Specifications

Voltage Rating:200V AC/DC
 Current Rating:1.5Amp(AWG#26)
 Withstanding Volatge:1000V AC/minute
 Operating Temperature:-25°C to +85°C
 Insulation Resistance:1000MΩ Min.
 Contact Resistance:30mΩ Max.
 Material;
 Contact Material:Phosphor Bronze
 Insulator Material: PA9T UL94V-0

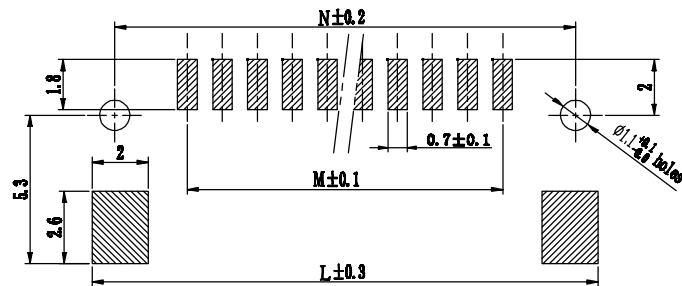
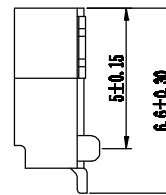
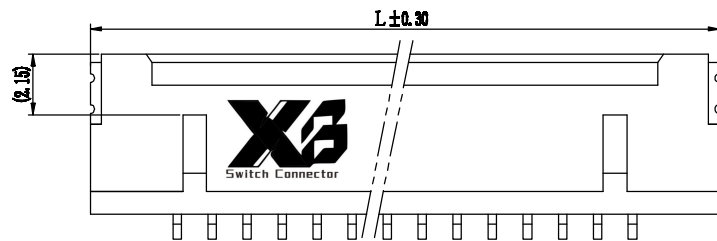
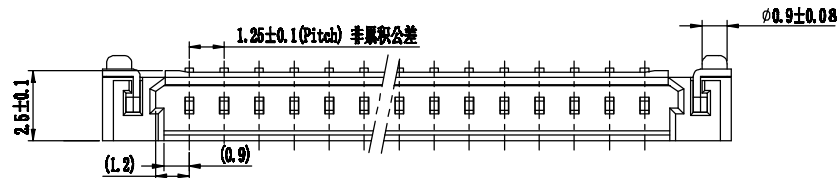

PCB Layout

| No of PIN/Row | Dimensions | | | No of PIN/Row | Dimensions | | |
|---------------|------------|-------|-------|---------------|------------|-------|-------|
| | M | N | L | | M | N | L |
| 3 | 2.5 | 7.7 | 8.7 | 17 | 20 | 25.2 | 26.2 |
| 4 | 3.75 | 8.95 | 9.95 | 18 | 21.25 | 26.45 | 27.45 |
| 5 | 5 | 10.2 | 11.2 | 19 | 22.5 | 27.7 | 28.7 |
| 6 | 6.25 | 11.45 | 12.45 | 20 | 23.75 | 28.95 | 29.95 |
| 7 | 7.5 | 12.7 | 13.7 | 21 | 25 | 30.2 | 31.2 |
| 8 | 8.75 | 13.95 | 14.95 | 22 | 26.25 | 31.45 | 32.45 |
| 9 | 10 | 15.2 | 16.2 | 23 | 27.5 | 32.7 | 33.7 |
| 10 | 11.25 | 16.45 | 17.45 | 24 | 28.75 | 33.95 | 34.95 |
| 11 | 12.5 | 17.7 | 18.7 | 25 | 30 | 35.2 | 36.2 |
| 12 | 13.75 | 18.95 | 19.95 | 26 | 31.25 | 36.45 | 37.45 |
| 13 | 15 | 20.2 | 21.2 | 27 | 32.5 | 37.7 | 38.7 |
| 14 | 16.25 | 21.45 | 22.45 | 28 | 33.75 | 38.95 | 39.95 |
| 15 | 17.5 | 22.7 | 23.7 | 29 | 35 | 40.2 | 41.2 |
| 16 | 18.75 | 23.95 | 24.95 | 30 | 36.25 | 41.45 | 42.45 |

Ordering Information

XB-X125-PCB-106A - XX XX B 002 D X A X

No. of Pins per Row
03~30

Standard Plating
02=Gold Flash
Selective Plating
01=Tin
22=Matte Tin

Color
2=White

Standard Packing
D=Tape&Reel

XB 东莞市溪榜电子有限公司
DONG GUAN XI BANG ELECTRONICS CO., LTD

3RD.ANG
PROJ.

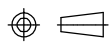

PAGE. 1/1

GENERAL TOLERANCE

| | |
|------------|-----------|
| X.±3.0' | X.±/ |
| .X'±2.0' | .X±0.25 |
| .XX'±1.5' | .XX±0.20 |
| .XXX'±1.0' | .XXX±0.10 |

DESIGNED:

DATE:

CHECKED:

DATE:

APPROVED:

DATE:

DWG. NO.

XB-X125-PCB-106A

PART NO.

TITLE.

Pitch 1.25mm WTB 90° SMT
Single Row Right-Angle

| REV. | UNIT. | SCALE. |
|------|-------|--------|
| A | mm | 1:1 |

F

E

D

C

B

A

F

E

D

C

A

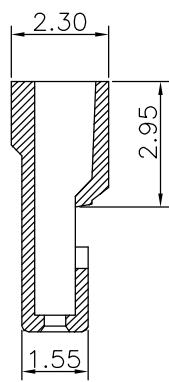
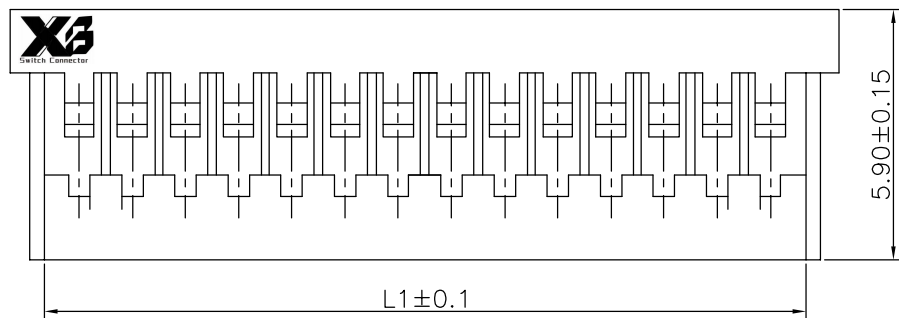

Specifications

- Current Rating: 1.0A AC
- Current Voltage: 100V AC
- Insulation Resistance: $\geq 500M\Omega$
- Dielectric Withstanding Voltage: 500VAC
- Contact Resistance: $\leq 30m\Omega$
- Operating Temperature: $-25^{\circ}C$ to $+85^{\circ}C$

Materials

- Insulator Material: Nylon-66, UL 94V-0
- Mating Terminal: GRD119-T1
- All materials must meet hazardous substances control standards.

| No. of Pins/Row | Dimensions Information | | |
|-----------------|------------------------|-------|-------|
| | M | L1 | L |
| 02 | 1.25 | 2.90 | 4.50 |
| 03 | 2.50 | 4.15 | 5.75 |
| 04 | 3.75 | 5.40 | 7.00 |
| 05 | 5.00 | 6.65 | 8.25 |
| 06 | 6.25 | 7.90 | 9.50 |
| 07 | 7.50 | 9.15 | 10.75 |
| 08 | 8.75 | 10.40 | 12.00 |
| 09 | 10.00 | 11.65 | 13.25 |
| 10 | 11.25 | 12.90 | 14.50 |
| 11 | 12.50 | 14.15 | 15.75 |
| 12 | 13.75 | 15.40 | 17.00 |
| 13 | 15.00 | 16.65 | 18.25 |
| 14 | 16.25 | 17.90 | 19.50 |
| 15 | 17.50 | 19.15 | 20.75 |
| 16 | 18.75 | 20.40 | 22.00 |
| 17 | 20.00 | 21.65 | 23.25 |
| 18 | 21.25 | 22.90 | 24.50 |
| 19 | 22.50 | 24.15 | 25.75 |
| 20 | 23.75 | 25.40 | 27.00 |
| 21 | 25.00 | 26.65 | 28.25 |
| 22 | 26.25 | 27.90 | 29.50 |
| 23 | 27.50 | 29.15 | 30.75 |
| 24 | 28.75 | 30.40 | 32.00 |
| 25 | 30.00 | 31.65 | 33.25 |
| 26 | 31.25 | 32.90 | 34.50 |
| 27 | 32.50 | 34.15 | 35.75 |
| 28 | 33.75 | 35.40 | 37.00 |
| 29 | 34.50 | 36.65 | 38.25 |
| 30 | 35.75 | 37.90 | 39.50 |

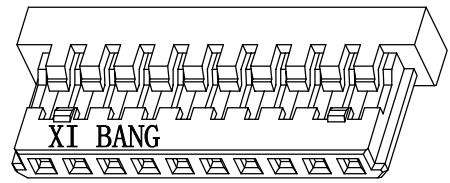
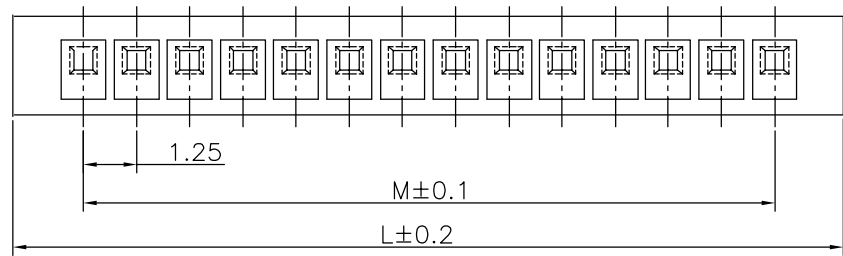

Ordering Information

XB-X125-PCB-106M- XX A XX
 No. of Pins Per Row SEE TABLE Materials /Color M=Nylon66/White

| | | | | | | | |
|---|---------------|-------------------|----------|-----------|-------|------------------------------|--------------------------|
| 东莞市溪榜电子有限公司 DONG GUAN XI BANG ELECTRONICS CO., LTD | 3RD.ANG PROJ. | GENERAL TOLERANCE | | DESIGNED: | DATE: | DWG. NO. XB-X125-PCB-106M | TITLE. 1.25mm HOUSING |
| | PAGE. 1/1 | X.*±3' | X.±/ | CHECKED: | DATE: | | |
| | | .X*±0.5' | .X±0.25 | APPROVED: | DATE: | | |
| | | .XX*±/' | .XX±0.12 | | | | |
| REV. A | UNIT. mm | SCALE. 1:1 | | | | | |

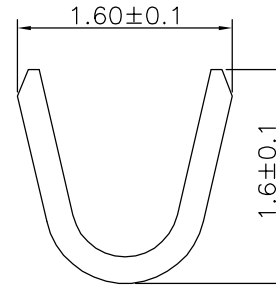
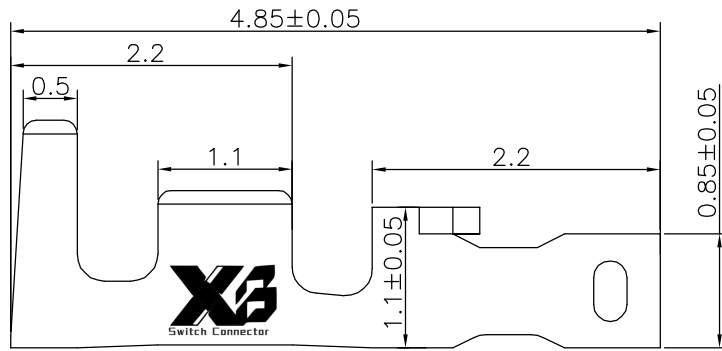

Specifications

Current Rating: 1.0A AC
 Current Voltage: 100V AC
 Contact Resistance: ≤30mΩ
 Operating Temperature: -25°C to +85°C
 Wire Range: AWG#26~#32

Materials

Terminal Material: Phosphor Bronze
 Mating Terminal: GHD171-HA
 All materials must meet XI BANG hazardous substances control standards.

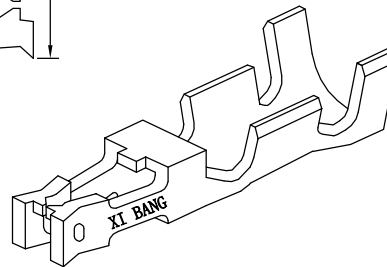
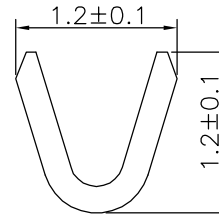
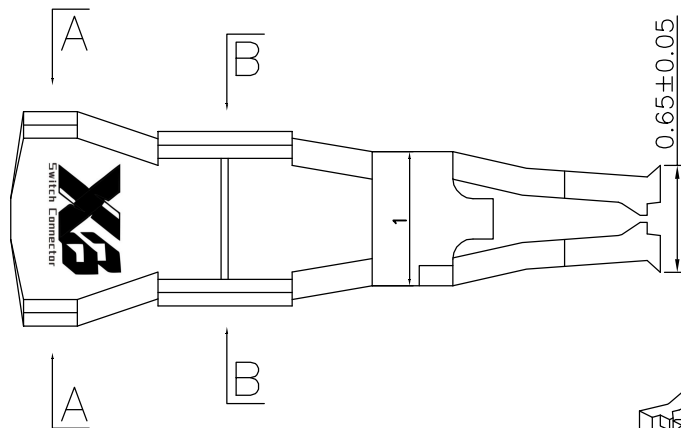

Ordering Information

XB-X125-PCB-106D XX

XX

Standard Plating
 01= Tin

Materials
 AB= Phosphor bronze

东莞市溪榜电子有限公司
 DONG GUAN XI BANG ELECTRONICS CO., LTD

3RD.ANG PROJ.

GENERAL TOLERANCE

| | |
|----------|-----------|
| X.*±3* | X.±/ |
| .X*±0.5* | .X±0.25 |
| .XX*±/* | .XX±0.12 |
| .XXX*±/* | .XXX±0.05 |

DESIGNED:
 CHECKED:
 APPROVED:

DATE:
 DATE:
 DATE:

DWG. NO.
 XB-X125-PCB-106D
 PART NO.

TITLE.
 3.50mm HOUSING

| | | | |
|--------|----------|------------|-----------|
| REV. A | UNIT. mm | SCALE. 1:1 | PAGE. 1/1 |
|--------|----------|------------|-----------|