

1 2 3 4 5 6 7 8 9

F
E
D
C
B
A

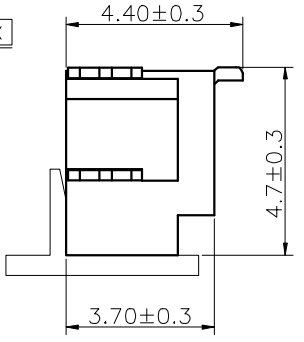
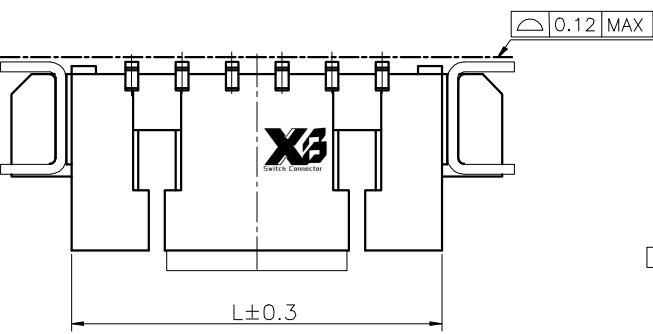

Specifications
 Current Rating:1Amp AC/DC
 Voltage Rating:125V AC/DC
 Contact Resistance:20mΩ Max.
 Insulation Resistance:100MΩ Min.
 Dielectric Withstanding Voltage:500VAC
 Temperature Range:-40°C to +105°C
 Materials
 Contact Material:Bhosphor Bronze
 Insulator Material:LCP UL 94V-0
 All materials must meet XI BANG hazardous substances control standards.

CIRCUITS	L	M
02	4.25	1.25
03	5.50	2.50
04	6.75	3.75
05	8.00	5.00
06	9.25	6.25
07	10.50	7.50
08	11.75	8.75
09	13.00	10.00
10	14.25	11.25
11	15.50	12.50
12	16.75	13.75
13	18.00	15.00
14	19.25	16.25
15	20.50	17.50

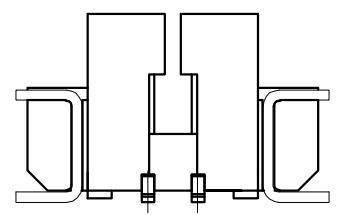
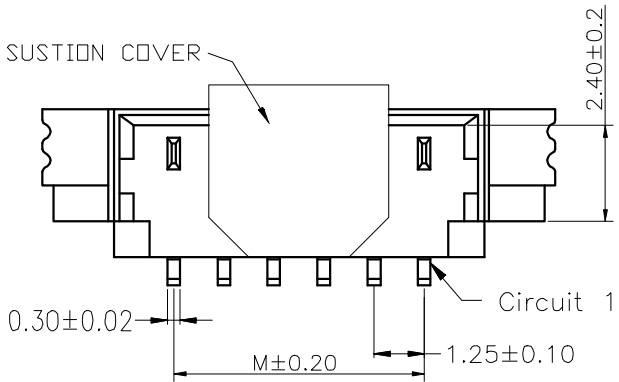

2P圖示

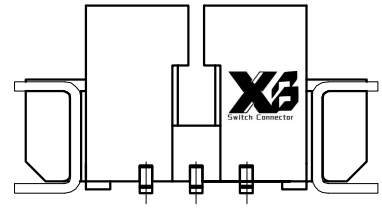

3P圖示

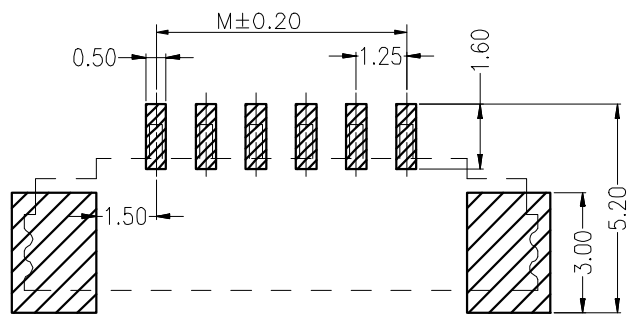

PCB ALYOUT(±0.05)

Ordering Information

XB-X125-PCB-102 - XX XX A 012 C X A X

No. of Pins per Row 02~15 Standard Plating 01=Tin Color 2=White Standard Packing F=CAP+Tape&Reel

XB 东莞市溪榜电子有限公司
 DONG GUAN XI BANG ELECTRONICS CO., LTD

REV. 01	UNIT. mm	SCALE. 1:1	PAGE. 1/1	
---------	----------	------------	-----------	--

GENERAL TOLERANCE	
X.±	X.±
.X'±	.X±0.25
.XX'±	.XX±0.15
.XXX'±	.XXX±0.10

DESIGNED:	DATE:
CHECKED:	DATE:
APPROVED:	DATE:

DWG. NO.
XB-X125-PCB-102
 PART NO.

TITLE.
 1.25mm pitch Wafer

1 2 3 4 5 6 7 8 9

F
E
D
C
B
A

1 2 3 4 5 6 7 8 9

F

E

D

C

B

A

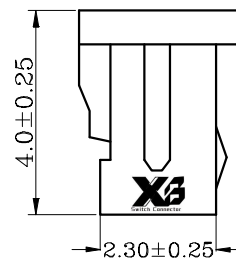
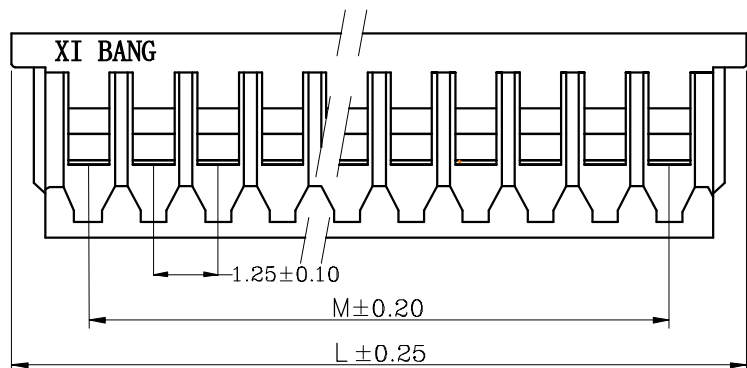
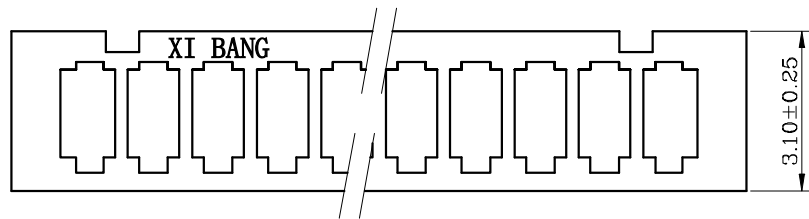

NOTES:

CURRENT RATING:1A AC/DC.
 VOLTAGE RATING:125V AC/DC
 TEMPERATURE RANGE:-40°C~+105°C.
 CONTACT RESISTANCE:20MΩ Max.
 INSULATION RESISTANCE:100MΩ Min.
 WITHSTANDING VOLTAGE:500V AC/MINUTE.
 MATERIAL:NYLON 66.UL94V-0.

No of Pin/Row	Dimensions	
	M	L
02	1.25	4.25
03	2.50	5.50
04	3.75	6.75
05	5.00	8.00
06	6.25	9.25
07	7.50	10.50
08	8.75	11.75
09	10.00	13.00
10	11.25	14.25
11	12.50	15.50
12	13.75	16.75
13	15.00	18.00
14	16.25	19.25
15	17.50	20.50
16	18.75	21.75

XB-X125-PCB-102M - XX A X

No. of Pin/Row
02 ~ 16

Material/Color
M=Nylon66/White

XB 东莞市溪榜电子有限公司
 DONG GUAN XI BANG ELECTRONICS CO., LTD

3RD.ANG PROJ.

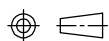

PAGE. 1/1

GENERAL TOLERANCE

X.'±5.0'	X.±
.X'±3.0'	.X±0.30
.XX'±2.0'	.XX±0.25
.XXX'±1.0'	.XXX±0.15

DESIGNED:

DATE:

CHECKED:

DATE:

APPROVED:

DATE:

DWG. NO.
XB-X125-PCB-102M

PART NO.

TITLE.

1.25mm pitch housing

REV. A	UNIT. mm	SCALE. 1:1
--------	----------	------------

1 2 3 4 5 6 7 8 9

F

E

D

C

B

A

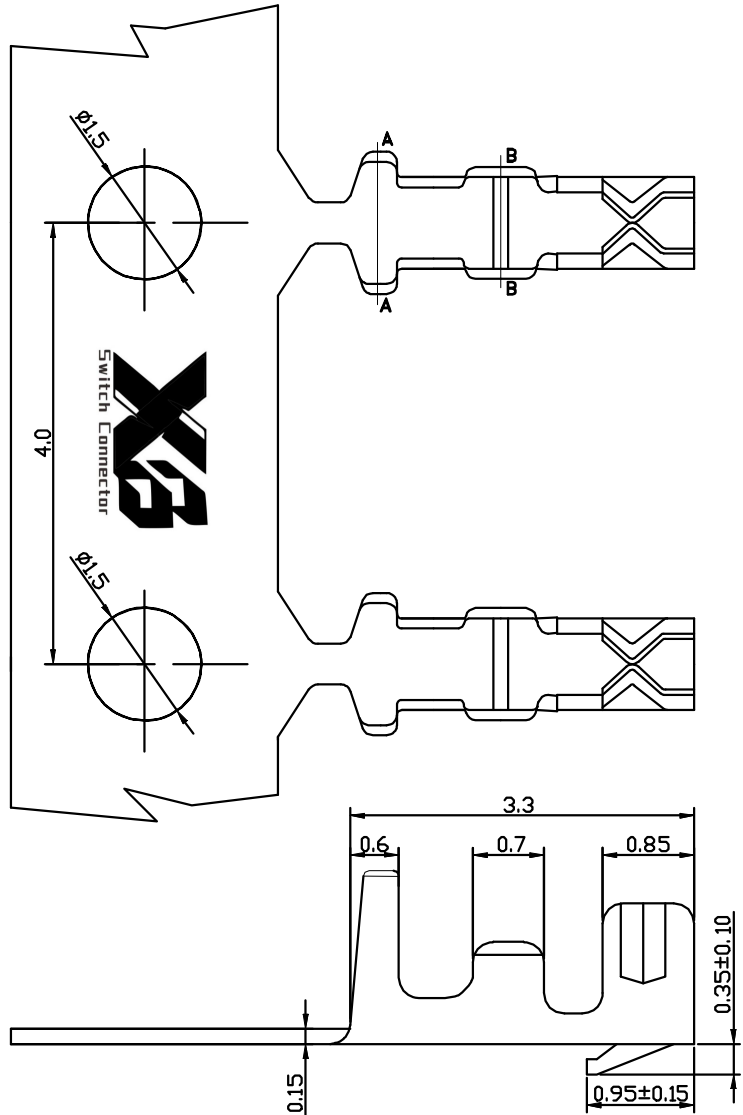

- Specifications:**
1. Material: Phosphor Bronze
 2. Wire Range: AWG#28-32
 3. Insulation O. D. : 1.0mm(Max)

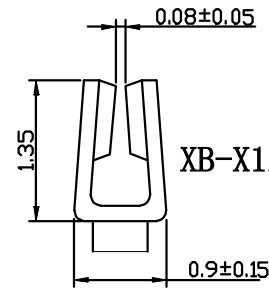
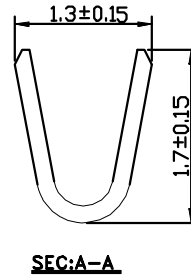
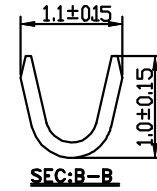

Ordering Information

XB-X125-PCB-102D - 01 XX AB

Standard Plating
01=Tin

Materials
AB=Phosphor bronze

XB 东莞市溪榜电子有限公司
DONG GUAN XI BANG ELECTRONICS CO., LTD

3RD.ANG
PROJ.

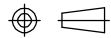

PAGE. 1/1

GENERAL TOLERANCE

X. 停 / X.?

.XX 停 / .X?.30

.XXX 停 / .XXX?.25

.XXX 停 / .XXX?. 15

DESIGNED:

DATE:

DWG. NO.

XB-X125-PCB-102D

TITLE.

1.25mm Pitch terminal

CHECKED:

DATE:

PART NO.

APPROVED:

DATE:

REV. A

UNIT. mm

SCALE. 1:1