

1 2 3 4 5 6 7 8 9

F

E

D

C

B

A

F

E

D

C

B

A

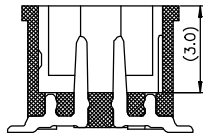
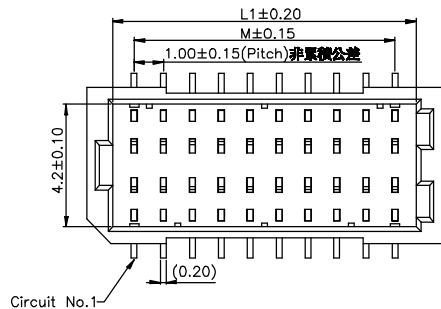

SEC:A-A

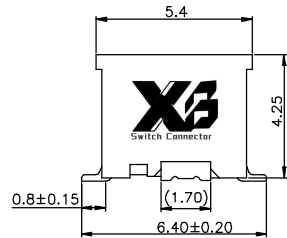
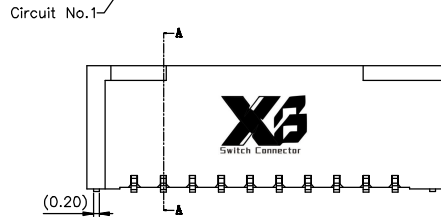

NOTES:

1. MATERIAL
 - 1-1. HOUSING: PA9T UL94V-0
 - 1-2. CAP: PA9T UL94V-0
 - 1-3. CONTACT: PHOSPHOR BRONZE
 - 1-4. FITTING NAIL: PHOSPHOR BRONZE
 2. PLATING SEE PART NUMBER
 3. RATING
 - 3-1. OPERATING TEMPERATURE: -25~85°C
 - 3-2. OPERATING VOLTAGE: 50V AC/DC
 - 3-3. CURRENT RATING: 1AMPS(28#)
 - 3-4. DIELECTRIC WITHSTANDING VOLTAGE: 500V AC/Minute;
 - 3-5. INSULATION RESISTANCE: 100MΩ Min;
 - 3-6. CONTACT RESISTANCE: 0.03Ω Max;
- All materials must meet XI BANG hazardous substances control standards.

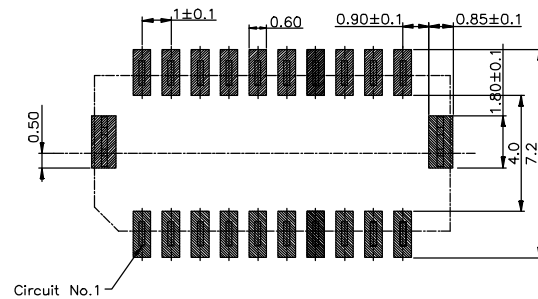
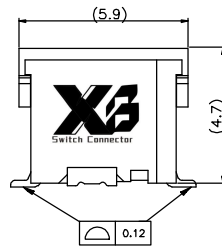
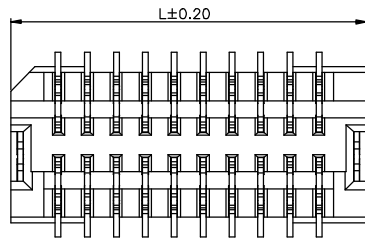

No of pins/row	Dimensions		
	M	L1	L
06	5	6.5	8.3
08	7	8.5	10.3
10	9	10.5	12.3
15	14	15.5	17.3
20	19	20.5	22.3
25	24	25.5	27.3

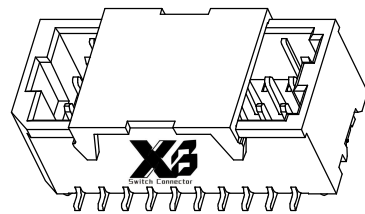
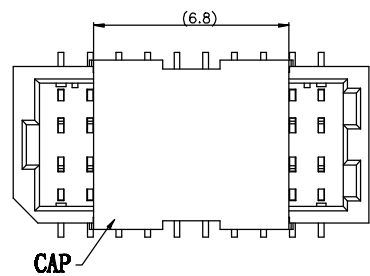

XB-X10-PCB-201-A001- XX XX A 001 D X A X

No. of Pins per Row: 6;8;10;15;20;25

Standard Plating: 02=Gold flash, Selective Plating: 01=Tin, 22=Matte Tin

Color: 1=Black, 2=White

Standard Packing: F=CAP+Tape&Reel, Selective Packing: D=Tape&Reel

XB 东莞市溪榜电子有限公司
DONG GUAN XI BANG ELECTRONICS CO., LTD

3RD.ANG PROJ.
PAGE. 1/1

GENERAL TOLERANCE	
X: ±/	X. ±/
.X: ±/	.X ±0.25
.XX: ±/	.XX ±0.20
.XXX: ±/	.XXX ±0.15

DESIGNED:
CHECKED:
APPROVED:

DATE:
DATE:
DATE:

DWG. NO.
XB-X10-PCB-201-A001
PART NO.

TITLE.
1.00mm WTB CONNECTOR
180° SMT

REV. 01 UNIT. mm SCALE. 1:1

1 2 3 4 5 6 7 8 9

F
E
D
C
B
A

F
E
D
C
B
A

1 2 3 4 5 6 7 8 9

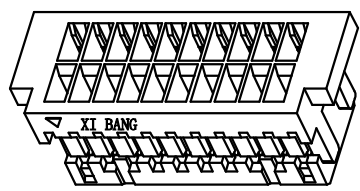
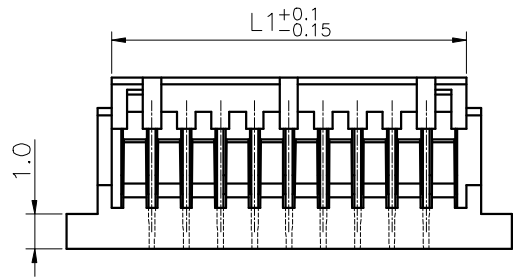

Specifications
 Operating Voltage:50V AC/DC
 Current Rating:1Amp(28#)
 Insulation Resistance:100MΩ Min.
 Dielectric Withstanding Volatge:500VAC
 Contact Resistance:30mΩ Max.
 Operating Temperature:-25°C to +85°C
 Materials
 Material:PBT UL94V-0
 All materials must meet XI BANG
 hazardous substances control standards.

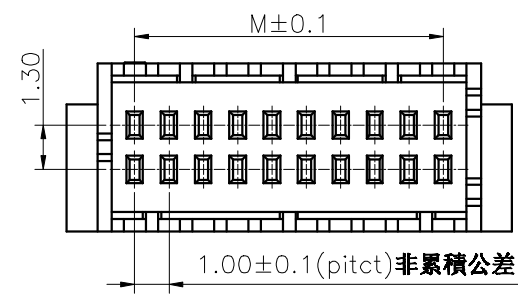
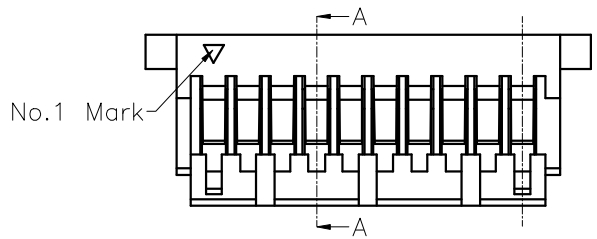
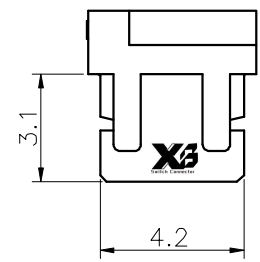
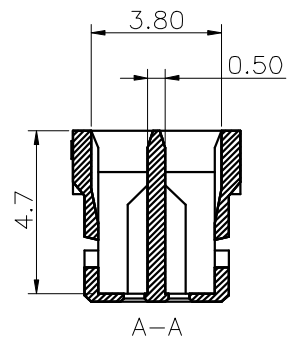
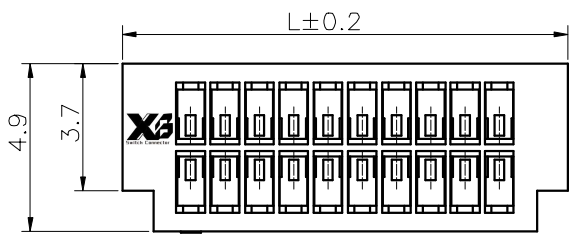

Ordering Information

XB-X10-PCB-201-A001M- XX A XX

No. of Pins/Row
 06. 08. 10. 15. 20. 25

Material/Color
 E=PBT/White

No. of Pins	M	L1	L
06	5.0	6.4	9
08	7.0	8.4	11
10	9.0	10.4	13
15	14.0	15.4	18
20	19.0	20.4	23
25	24.0	25.4	28

XB 东莞市溪榜电子有限公司
 DONG GUAN XI BANG ELECTRONICS CO., LTD

GENERAL TOLERANCE	
X.*±3.0'	X.±
.X'±1.0'	.X±0.25
.XX'±	.XX±0.15
.XXX'±	.XXX±0.10

DESIGN:
 CHECKED:
 AUDITED:

DATE:
 DATE:
 DATE:

DWG. NO.
XB-X10-PCB-201-A001M
 PART NO.

TITLE.
 SHD 1.0mm pitch
 Dual row HSG

REV.	UNIT.	SCALE.	PAGE.
A	mm	1:1	1/1

1 2 3 4 5 6 7 8 9

1 2 3 4 5 6 7 8 9

F

E

D

C

B

A

F

E

D

C

B

A

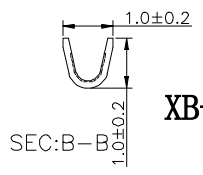
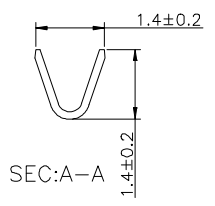
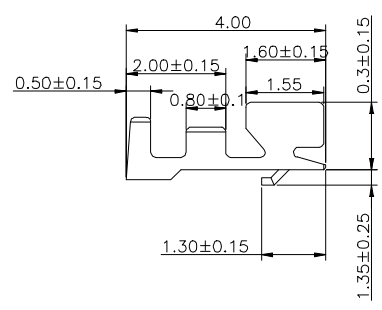
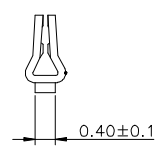
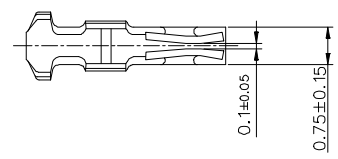
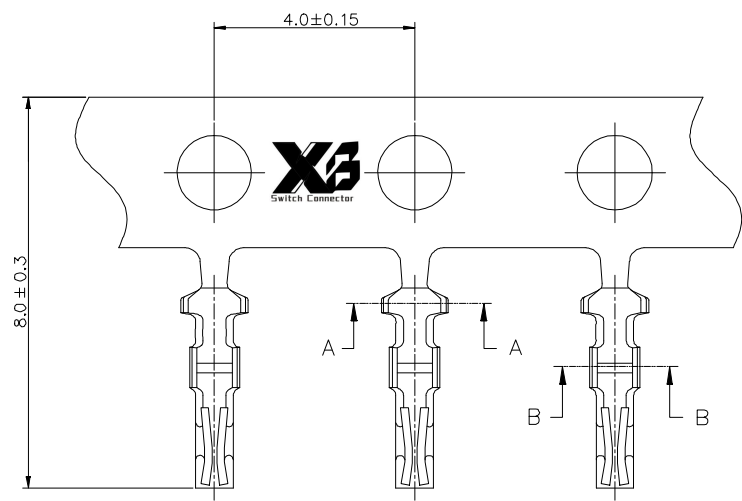

Ordering Information

XB-X10-PCB-201-A001D - 02 XX AB

Standard Plating
01=Tin

RATING
 OPERATING TEMPERATURE: -25~85°C
 OPERATING VOLTAGE: 150V AC/DC
 CURRENT RATING: 1.0 AMPS
 DIELECTRIC WITHSTANDING VOLTAGE:
 800V AC/Minute;
 INSULATION RESISTANCE: 1000MΩ Min;
 CONTACT RESISTANCE: 0.03Ω Max;

		东莞市溪榜电子有限公司		DONG GUAN XI BANG ELECTRONICS CO., LTD	
REV. B	UNIT. mm	SCALE. 1:1	PAGE. 1/1		

GENERAL TOLERANCE	
X.* ± 5.0°	X. ± 0.30
.X* ± 3.0°	.X ± 0.25
.XX* ± 2.0°	.XX ± 0.15
.XXX* ± 1.0°	.XXX ± 0.10

DESIGNED:	DATE:
CHECKED:	DATE:
APPROVED:	DATE:

DWG. NO. XB-X10-PCB-201-A001D	TITLE.
PART NO.	1.0T-端子

1 2 3 4 5 6 7 8 9