

1 2 3 4 5 6 7 8 9

F

E

D

C

B

A

F

E

D

C

B

A

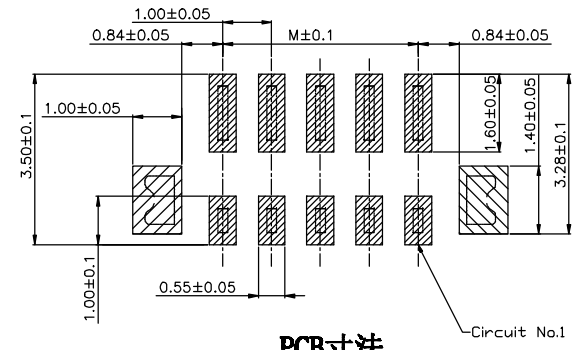
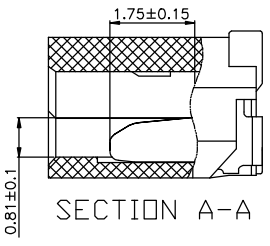
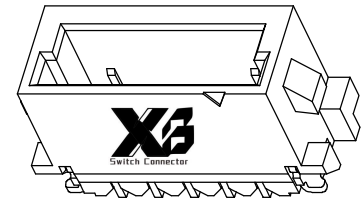
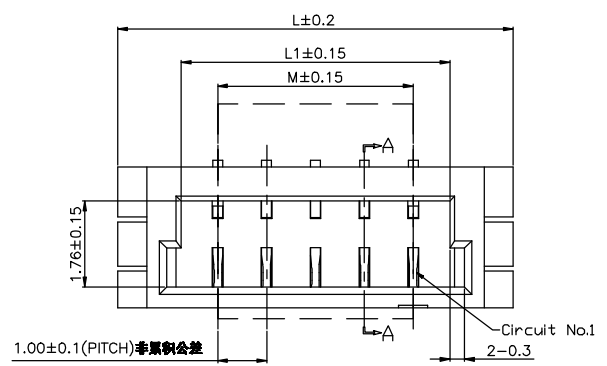

**PCB寸法
PCB Layout**

Specifications
 Current Rating: 1.3Amp
 Insulation Resistance: 100MΩ Min.
 Dielectric Withstanding Voltage:
 500VAC/minute
 Contact Resistance: 0.03mΩ Max.
 Operating Temperature: -25°C to +85°C
 Operation Voltage: 125V AC/DC
 Materials
 Contact Material: Phosphor Bronze
 Fitting Nails: Phosphor Bronze
 Housing Material: Nylon-9T, UL 94V-0
 CAP: Nylon-9T, UL 94V-0
 All materials must meet **XI BANG**
 hazardous substances control standards.

TABLE:

No of pins/row	M	L1	L
5	4.0	5.5	8.1

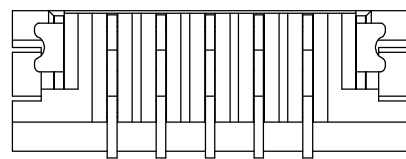
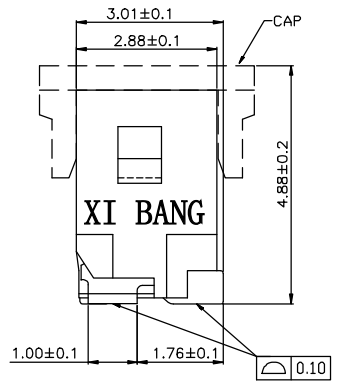
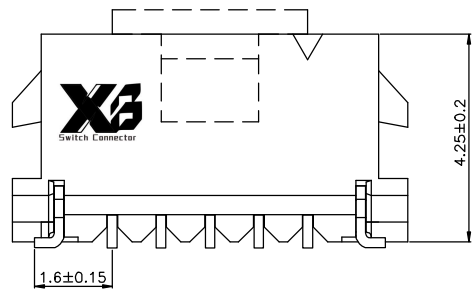

XB-X10-PCB-106-A004 - XX XX A 004 D X A X

No. of Pins per Row **SEE TABLE** Standard Plating 01=Tin
 Color 1=Black 2=White
 Standard Packing F= CAP+Tape&Reel Selective Packing D= Tape&Reel

东莞市溪榜电子有限公司
 DONG GUAN XI BANG ELECTRONICS CO., LTD

3RD.ANG PROJ.
 1/1

REV. A UNIT. mm SCALE. 1:1

GENERAL TOLERANCE	
X.'±3'	X.±/
.X'±0.5'	.X±0.25
.XX'±/	.XX±0.12
.XXX'±/	.XXX±0.05

DESIGNED:
 CHECKED:
 APPROVED:

DATE:
 DATE:
 DATE:

DWG. NO.
XB-X10-PCB-106-A004
 PART NO.

TITLE.
 1.0 WTB CONN.
 SMT SINGLE ROW
 RIGHT-ANGLE

1 2 3 4 5 6 7 8 9

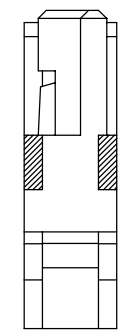
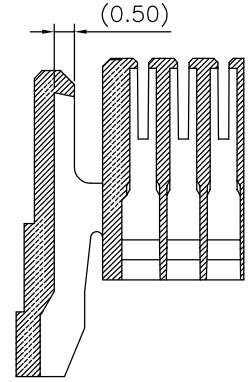
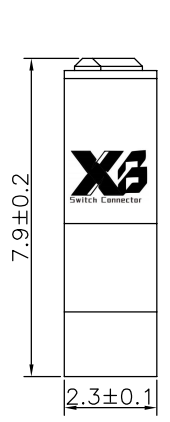
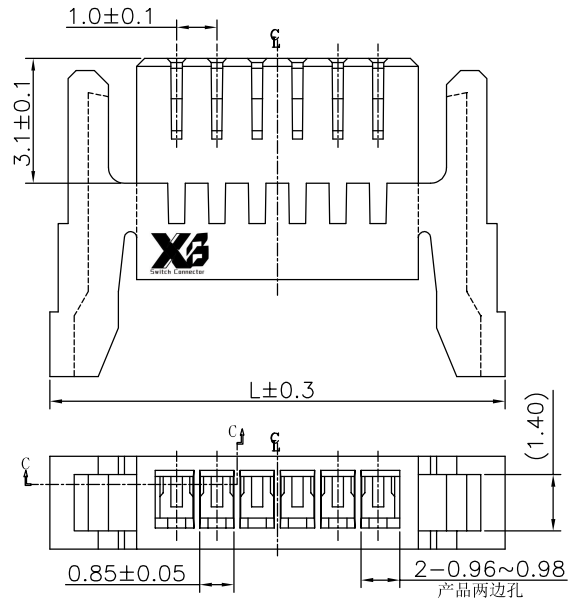

Specifications
 Current Rating: 1.0Amps
 Current Voltage: 125V AC/DC
 Insulation Resistance: 100MΩ Min.
 Dielectric Withstanding Voltage: 500VAC/minute
 Contact Resistance: 0.03Ω Max.
 Operating Temperature: -25°C to +85°C

Materials
 Insulator Material: Nylon-66, UL 94V-0
 Mating Terminal: GRC114-T1
 All materials must meet **XI BANG** hazardous substances control standards.

SECTION C-C

SECTION D-D

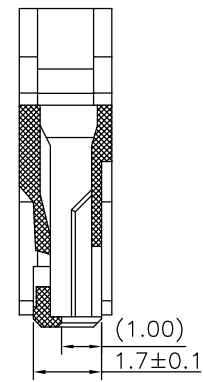
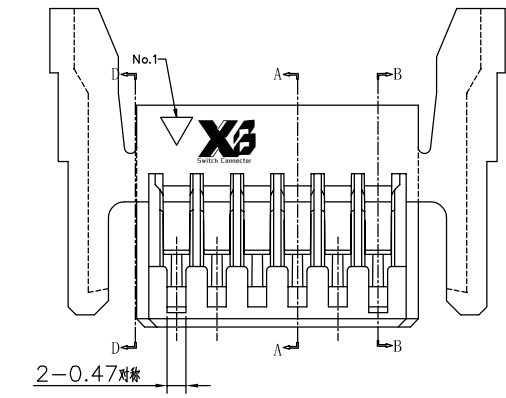

SECTION B-B

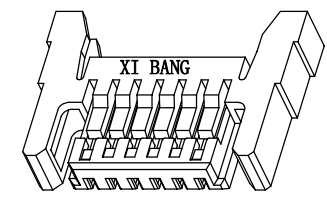

No. of Pins/Row	Dimensions Information		
	M	L1	L
05	4.00	6.00	10.30

SECTION A-A

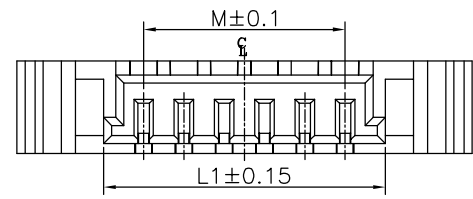

Ordering Information

XB-X10-PCB-106-A004M - XX A XX

No. of Pins Per Row SEE TABLE
 Materials /Color M=Nylon66/White

XB 东莞市溪榜电子有限公司
 DONG GUAN XI BANG ELECTRONICS CO., LTD

REV. A UNIT. mm SCALE. 1:1

3RD.ANG PROJ.
 PAGE. 1/1

GENERAL TOLERANCE	
X.*±3*	X.±/
.X*±0.5*	.X±0.25
.XX*±/*	.XX±0.12
.XXX*±/*	.XXX±0.05

DESIGNED:
 CHECKED:
 APPROVED:

DATE:
 DATE:
 DATE:

DWG. NO.
 XB-X10-PCB-106-A004-M
 PART NO.

TITLE:
 1.0mm HOUSING

1 2 3 4 5 6 7 8 9

F

E

D

C

B

A

F

E

D

C

B

A

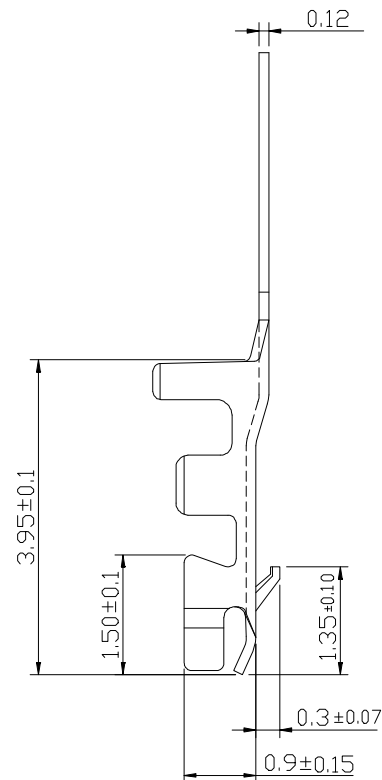
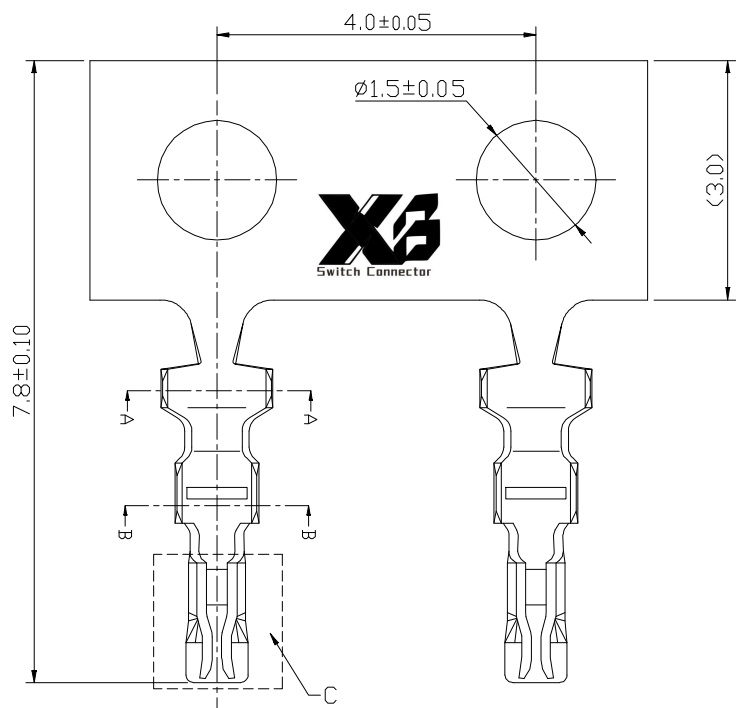

NOTES:

OPERATING TEMPERATURE: -25~85°C
 OPERATING VOLTAGE: 150V AC/DC
 CURRENT RATING: 1.0 AMPS
 DIELECTRIC WITHSTANDING VOLTAGE:
 500V AC/Minute;
 INSULATION RESISTANCE:100MΩ Min;
 CONTACT RESISTANCE:0.03Ω Max;

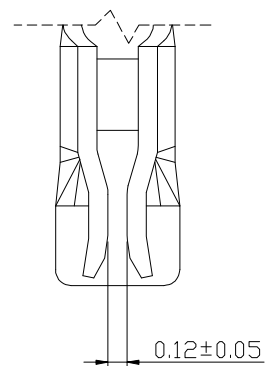

DETAIL: C SCALE 2: 1

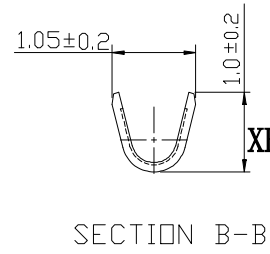
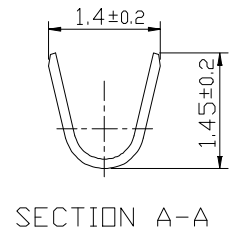
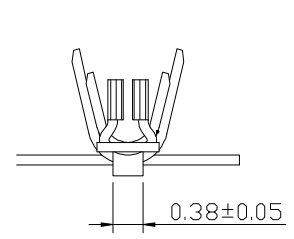

Ordering Information

XB-X10-PCB-106-A004D - 01 XX AB

Standard Plating
 01=Tin
 02=Gold flash

Materials
 AB=Phosphor Bronze

XB 东莞市溪榜电子有限公司
 DONG GUAN XI BANG ELECTRONICS CO., LTD

3RD.ANG
 PROJ.

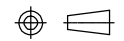

PAGE. 1/1

GENERAL TOLERANCE

X.停 /	X.?
.X停 /	.X?.25
.XX停 /	.XX?.20
.XXX停 /	.XXX?. 15

DESIGNED:

CHECKED:

APPROVED:

DATE:

DATE:

DATE:

DWG. NO.

XB-X10-PCB-106-A004D

PART NO.

TITLE.

1.0 WTB CONN.PLUG CRIMP TERMINAL

REV. A UNIT. mm SCALE. 1:1

1 2 3 4 5 6 7 8 9